

SPARES LIST

FOR

1949 and 1950 MODEL 7R

348 c.c. O.H.C.

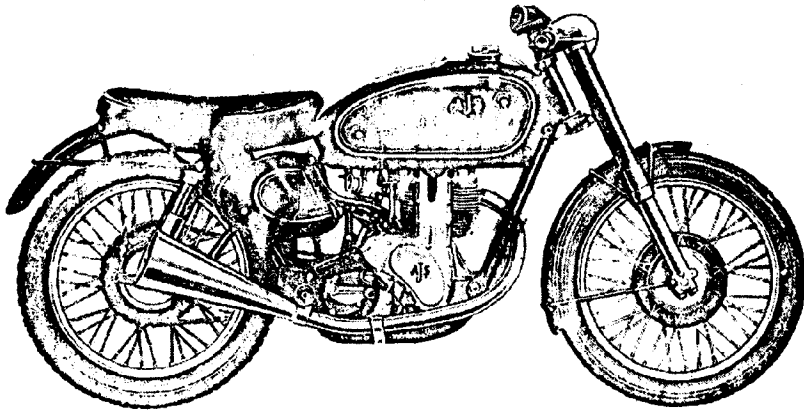

A.J.S.

Compiled and Issued by the Manufacturers:

A·J·S MOTOR CYCLES

(Proprietors: ASSOCIATED MOTOR CYCLES LIMITED)

Registered Offices:

PLUMSTEAD ROAD, PLUMSTEAD
LONDON, S.E.18 .. ENGLAND

Nearest Station:
WOOLWICH ARSENAL,
(Southern Region Railway)

Factories:
BURRAGE GROVE and MAXEY ROAD
PLUMSTEAD, S.E.18

Telegrams and Cables: "ICANHOPIT-WOL-LONDON"
Telephone: WOOLWICH 1223 (5 Lines)
Codes: A.B.C. 5th and 6th Edition; Bentley's; and Private Codes

All correspondence to:
A·J·S MOTOR CYCLES, PLUMSTEAD ROAD, LONDON, S.E.18

Price: TWO SHILLINGS and SIXPENCE

EDITION CL-16

(1) TERMS OF BUSINESS.

Our terms are :— CASH WITH ORDER,
CASH AGAINST PRO-FORMA INVOICE, OR
APPROVED LEDGER ACCOUNT.

Other than in exceptional cases we do not send goods by "CASH ON DELIVERY" (C.O.D.). Note the minimum postage fee for a C.O.D. parcel is ten pence.

Customers who wish to avoid delay can open deposit accounts and the usual deposit is £5.

Orders from abroad should be accompanied by a remittance to cover the costs of goods and postal charges, but we shall be pleased to supply by "CASH ON DELIVERY" (V.P.P.) where that system is in operation. In the latter instance, a deposit of approximately twenty-five per cent. of the value of the goods must be remitted with the order.

(2) PRICES AND SPECIFICATIONS.

All prices, specifications and conditions are subject to alteration without notice. The prices of spares do not include the costs of packing and carriage.

(3) CARRIAGE AND PACKING.

All invoices for spare parts will be SURCHARGED by FIVE PER CENT. to cover the cost of packing and postage, or carriage, and the minimum surcharge is sixpence.

A special packing case, or crate, is required for some spares to ensure freedom from damage in transit. In such circumstances a special charge for the value of the case, or crate, will be made in addition to the five per cent. surcharge but the special charge will be credited in full if the container is promptly returned to our factory carriage paid and in good condition.

(4) HOW TO ORDER SPARES.

STATE :— (a) The Model of the machine.

(b) The complete engine number. (See paragraph 5.)

(c) The frame number. (See paragraph 5.)

(d) The part numbers of the spares required.

(e) A description of each spare.

(f) The quantity required of each item.

(g) How the spares are to be sent. (Post, Parcels Post, Passenger train or Goods train.)

(h) Your full name and address. These particulars are best written in BLOCK LETTERS.

(i) Mention if, or not, you have an account with us.

ALSO :— Unless you have a deposit or ordinary account, enclose a remittance to cover the cost of the spares plus the five per cent. surcharge. (See paragraph 3.)

When cash is sent any excess will be refunded without prior application.

NOTE :— When sending orders by telegram or cable do not omit your name and address from the "message."

(5) IDENTITY.

To ensure the supply of correct spares it is essential we can identify the machine for which they are required. The ONLY WAY to do that is for us to know the COMPLETE ENGINE and frame numbers.

The engine number is stamped on the LEFT crankcase, UNDER THE CYLINDER, and may have one or more letters incorporated in it. THE COMPLETE NUMBER MUST BE QUOTED.

The frame number is stamped on the left-hand side of the frame head down tube lug.

(6) SERVICE.

The **SERVICE AND REPAIR DEPARTMENT** is situated in **BURRAGE GROVE, PLUMSTEAD, LONDON, S.E.18**, and is open on **Mondays to Fridays** from 8-30 a.m. to 12.55 p.m.—2 p.m. to 5-30 p.m. It is closed on **Saturdays, Sundays and National Holidays.**

It exists for the purpose of :—

- (a) Giving technical assistance verbally or through the Post.
- (b) Supplying spare parts over the counter or through the Post.
- (c) Repairing and re-conditioning machines, or parts of machines, of our make.

If it is considered necessary to bring a machine, or parts, to the factory for an urgent repair **IT IS ESSENTIAL** you make an appointment beforehand to avoid disappointment. This can be done by letter or telephone.

(7) REPAIRS.

The instructions regarding repairs should be clear and definite, otherwise the cost may be greater than that expected. We shall be pleased to give estimates for repairs if parts are sent to us for that purpose. If the estimate is accepted, no charge is made for the preliminary examination, but, should it be decided not to have the work carried out, it may be necessary to make a charge to cover the cost of whatever dismantling and re-assembly may have been done to prepare the estimate.

(8) REPAIRS TO PROPRIETARY FITTINGS.

We do not repair carburettors, chains, electrical equipment, saddles, sparking plugs, speedometers and tyres.

(9) PATTERNS.

Parts sent to us as patterns, or for repair, should have attached to them a label bearing the sender's full name and address. The instructions regarding such parts should be sent under separate cover.

(10) CORRESPONDENCE.

Our routine is organised into different departments. Therefore delay cannot be avoided if matters relating to more than one department are contained in one letter.

Consequently when communicating with more than one department it is desirable to do so on **SEPARATE SHEETS**. Each sheet should bear the sender's name and address. **IN PARTICULAR**, requests for **TECHNICAL ADVICE** should not be on the same sheets as **ORDERS FOR SPARE PARTS**.

**A·J·S MOTOR CYCLES,
PLUMSTEAD, LONDON, S.E.18**

NOTE

The numbers, in brackets, that appear in the "Description" columns relate to the numbered foot notes regarding items so specially indicated.

The quantities per machine of each item are entered in the "Qty" columns. "R" indicates as may be required.

The illustrations are not to scale and are not necessarily accurate in detail.

Some items are not illustrated. The detailed index is on inside rear cover.

It is essential all items marked * are fitted in the Factory. Therefore the units concerned must be sent to the Factory when replacements are required.

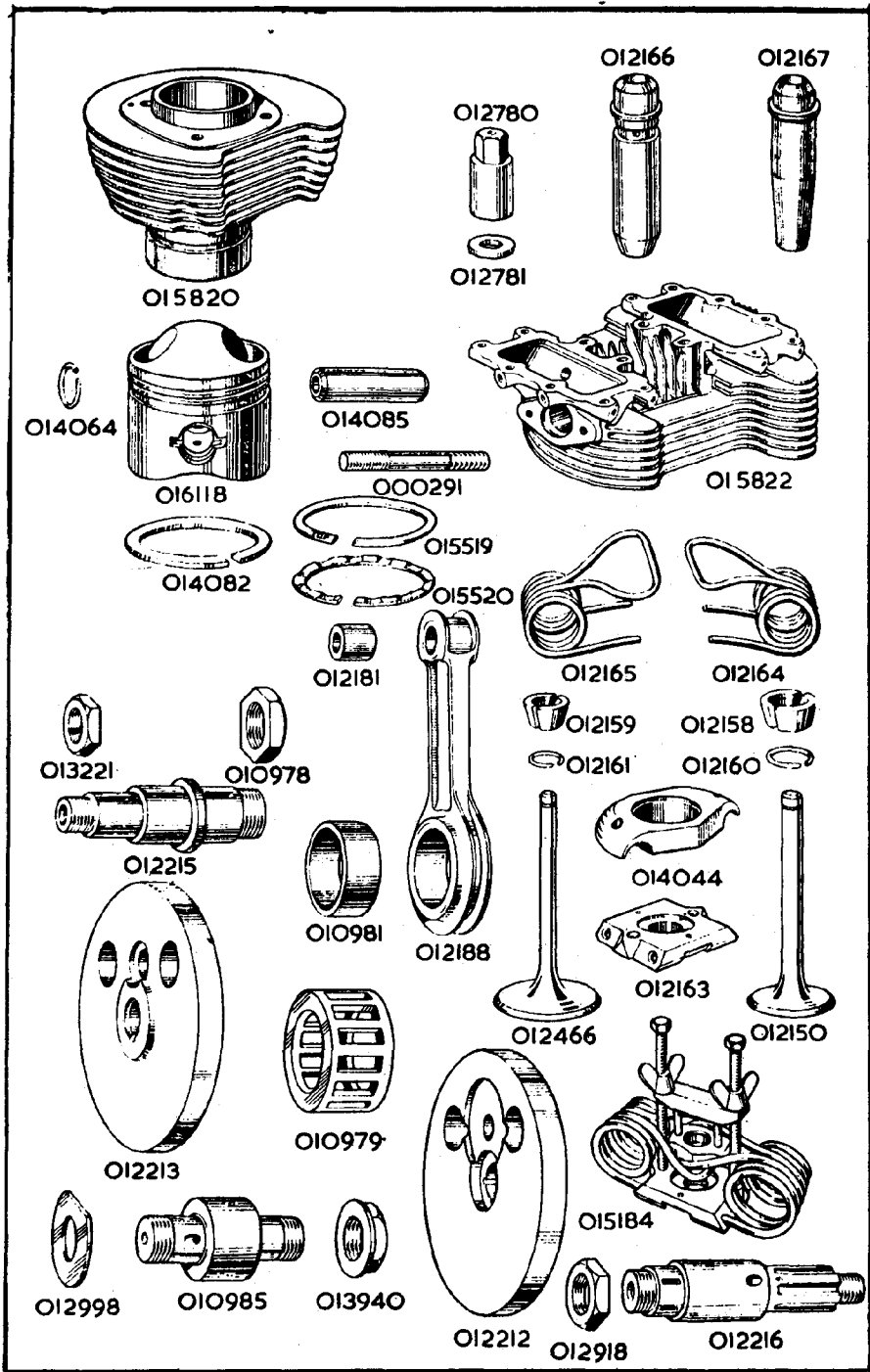

ENGINE SECTION

PART NUMBER	DESCRIPTION	QTY. OFF 49	QTY. OFF 50	Price on Application
012185	Cylinder	1	-	-
015820	Cylinder	-	1	-
012780	Nut, retaining cylinder and head	4	4	-
012781	Washer, steel, for cylinder head nut	4	4	-
014081	Piston, bare, for petrol (octane 72)	1	-	-
016118	Piston, bare, for petrol (octane 80)	-	1	-
014526	Piston, bare, for petrol-benzol	1	-	-
016454	Piston, bare, for petrol-benzol	-	-	-
013484	Piston, bare, for Methanol	1	-	-
016417	Piston, bare, for Methanol	-	1	-
014082	Ring, piston, compression (74 mm. by $\frac{3}{4}$ inch)	2	2	-
015519	Ring, piston, oil control, top, 74 mm.	1	1	-
015520	Ring, piston, oil control, bottom, 74 mm.	1	1	-
014085	Pin, gudgeon, for piston	1	1	-
014064	Circlip, retaining gudgeon pin	2	-	-
016451	Circlip, retaining gudgeon pin	-	2	-
012834	Piston, complete, for petrol (I) (octane 72)	1	-	-
016490	Piston, complete, for petrol (I) (octane 80)	-	1	-
015187	Piston, complete, for petrol-benzol (I)	1	-	-
016491	Piston, complete, for petrol-benzol (I)	-	1	-
015188	Piston, complete, for Methanol (I)	1	-	-
016492	Piston, complete, for Methanol (I)	-	1	-
015901	Gland, rubber, for oilways, between cylinder head and barrel	-	2	-

NOTE 1.—Includes:—

Piston, compression rings, oil control rings, gudgeon pin and circlips.

CYLINDER HEAD AND VALVES

014024	Head, cylinder, without valve guides	1	-	-
015822	Head, cylinder, without valve guides	-	1	-
012167	Guide, for inlet valve	1	-	-
014041	Guide, for inlet valve	-	1	-
012166	Guide, for exhaust valve	1	1	-
012466	Valve, inlet (Stem $\frac{1}{4}$ inch diameter)	1	-	-
014040	Valve, inlet (Stem $\frac{1}{8}$ inch diameter) / 45°	-	1	-
012150	Valve, exhaust (Stem $\frac{3}{8}$ inch diameter)	1	-	-
015834	Valve, exhaust (Stem $\frac{3}{8}$ inch diameter)	-	1	-
012164	Spring, inner, for valve (narrow prong spring)	2	2	-
012165	Spring, outer, for valve (wide prong spring)	2	2	-
012163	Seat, for valve spring	2	2	-
012162	Collar, for valve spring	2	-	-
014044	Collar, for valve spring	-	2	-
012161	Ring, retaining collet on inlet valve stem	1	-	-
012160	Ring, retaining collet on exhaust valve stem	1	-	-
012159	Collet, for inlet valve (in two pieces)	1	-	-
014042	Collet, for inlet valve (in two pieces)	-	1	-
012158	Collet, for exhaust valve (in two pieces)	1	-	-
014039	Collet, for exhaust valve (in two pieces)	-	1	-
000291	Stud, 2 inches by $\frac{1}{8}$ inch by 26 and 22, retaining carburettor to cylinder head	2	2	-
000004	Nut, for carburettor stud	2	2	-

PART NUMBER	DESCRIPTION	QTY. OFF 49	QTY. OFF 50	Price on Application
-------------	-------------	-------------	-------------	----------------------

FLYWHEELS, WITH CONNECTING ROD AND BIG-END BEARING

012213	... Flywheel, timing side.....	1	-	...
015768	... Flywheel, timing side.....	-	1	...
012215	... Axle, for timing side flywheel.....	1	-	...
015770	... Axle, for timing side flywheel.....	-	1	...
000572	... Key, for timing side flywheel axle.....	1	-	...
010978	... Nut, for timing side flywheel axle.....	1	-	...
012212	... Flywheel, driving side.....	1	-	...
015769	... Flywheel, driving side.....	-	1	...
012216	... Axle, for driving side flywheel.....	1	-	...
015771	... Axle, for driving side flywheel.....	-	1	...
000572	... Key, for driving side flywheel axle.....	2	-	2
012918	... Nut, for driving side flywheel axle.....	1	-	...
015775	... Nut, for driving side flywheel axle.....	-	1	...
012188	... Roc, connecting, with big-end liner and gudgeon pin bush.....	1	-	1
010981	... Liner, big-end, for connecting rod.....	1	-	1
012181	... Bush, gudgeon pin, for connecting rod.....	1	-	1
010985	... Crankpin.....	1	-	...
015774	... Crankpin.....	-	1	...
000572	... Key, for crankpin.....	-	1	...
010831	... Roller, for crankpin ($\frac{3}{8}$ inch diameter by $\frac{1}{8}$ inch long).....	14	-	14
010979	... Cage, for crankpin rollers.....	1	-	1
012998	... Washer, for crankpin.....	2	-	...
015776	... Washer, for crankpin.....	-	2	...
013940	... Nut, for crankpin.....	2	-	...
015775	... Nut, for crankpin.....	-	2	...

* See page 3, for terms of service.

CRANKCASE, WITH BEARINGS AND CLAMPING BOLTS

012768	... Crankcase (2).....	1	-	...
015750	... Crankcase (2).....	-	1	...
012779	... Stud, $5\frac{1}{8}$ inches by $\frac{3}{8}$ inch by 20 by 20 retaining cylinder and head.....	4	-	4
000575	... Plug, drain, for crankcase (with hexagon head).....	1	-	...
013331	... Plug, blocking oil passage (with round head).....	1	-	...
015989	... Plug, inspection, for front chain oiler.....	-	1	...
000200	... Washer, fibre, for oil passage plug.....	1	-	...
016009	... Washer, fibre, for inspection plug.....	-	1	...
015430	... Sump, for crankcase.....	-	1	...
015431	... Filter, for crankcase sump.....	-	1	...
015432	... Gasket, for crankcase sump filter.....	-	2	...
015433	... Stud, $1\frac{3}{8}$ inch by $\frac{1}{2}$ inch by 20 by 26 for retaining crankcase sump.....	-	3	...
015601	... Stud, $1\frac{3}{8}$ inch by $\frac{1}{2}$ inch by 20 by 26 for retaining crankcase sump.....	-	2	...
000012	... Washer, plain, for crankcase sump stud.....	-	5	...
011843	... Nut, for crankcase sump stud.....	-	5	...
011556	... Dowel, locating timing case.....	2	-	2
012978	... Sleeve, for timing side main bearing.....	1	-	1
012546	... Bearing, for timing side flywheel (3).....	1	-	...
016252	... Bearing, for timing side flywheel (4).....	-	1	...
012979	... Washer, locating timing side main bearing.....	1	-	1
000571	... Key, locating timing side main bearing.....	-	1	...
012957	... Sleeve, for driving side main bearing.....	1	-	1
012959	... Roller, $\frac{1}{8}$ inch diameter by $\frac{3}{8}$ inch long, for driving side main bearing.....	36	-	36
012956	... Cage, double row (inner position), for driving side main bearing rollers.....	1	-	1
012955	... Cage, single row (outer position), for driving side main bearing rollers.....	1	-	1

PART NUMBER	DESCRIPTION	QTY. OFF 49	QTY. OFF 50	Price on Application
012912	... Bolt, clamping front of crankcase at top ($2\frac{1}{8}$ inches under head by $\frac{1}{8}$ inch diameter).....	1	1	...
013956	... Bolt, clamping rear of crankcase at top ($2\frac{1}{4}$ inches under head by $\frac{1}{4}$ inch diameter, with $\frac{3}{8}$ inch threaded extension to accommodate front chain guard)	1	1	...
012911	... Stud, clamping crankcase in two lower front and one bottom rear positions ($4\frac{5}{8}$ inches long by $\frac{7}{8}$ inch diameter)	3	-	...
012911	... Stud, clamping crankcase in lower front and rear bottom positions ($4\frac{5}{8}$ inches long by $\frac{7}{8}$ inch diameter).....	-	2	...
016103	... Stud, clamping crankcase in front bottom position ($5\frac{1}{2}$ inches long by $\frac{7}{8}$ inch diameter)	-	1	...
000011	... Washer, steel, plain, for crankcase $\frac{3}{4}$ inch clamping bolts and studs	8	9	...
000004	... Nut, for crankcase $\frac{3}{4}$ inch clamping bolts and studs.....	6	7	...

NOTE 2.—Consists of both halves of crankcase fitted only with :—
 One sleeve 012978.
 One sleeve 012957.
 Four studs 012779.
 Separate halves of crankcase are not sold.

NOTE 3.—Dimensions :—
 Internal diameter 1 inch
 External diameter $2\frac{1}{2}$ inches
 Thickness $\frac{3}{8}$ inch
 The Manufacturer's Part Number is RMS-8.

NOTE 4.—This is identical to Bearing 012546 plus a channel cut in its outer race to accommodate the locating key 000571. Bearing 016252 can be used in lieu of bearing 012546 but not vice versa.

* See page 3, for terms of service.

TIMING CASE WITH TIMING GEAR AND MAGNETO AND OIL PUMP DRIVES

012587	... Case, timing.....	1	1	...
011556	... Dowel, locating pump support plate.....	2	2	...
013331	... Plug, inspection (with round head).....	1	1	...
000200	... Washer, fibre, for inspection plug.....	1	1	...
013908	... Scoop, oil, for timing side bearing.....	1	1	...
000105	... Rivet, fixing timing side bearing oil scoop, price per set of 3.....	3	3	...
012913	... Screw, $1\frac{1}{2}$ inch by $\frac{1}{2}$ inch by 20, retaining timing case to crankcase.....	10	10	...
012623	... Plate, supporting oil pumps.....	1	-	...
015763	... Plate, supporting oil pumps.....	-	1	...
012913	... Screw, $1\frac{1}{2}$ inch by $\frac{1}{2}$ inch by 20, retaining oil pump support plate to timing case.....	4	4	...
012588	... Cover, for timing case.....	1	1	...
012915	... Screw, $1\frac{1}{2}$ inch by 2 B.A. cheese head, short, retaining timing case cover. (The nine uppermost positions)...	9	9	...
000456	... Screw, $1\frac{1}{2}$ inch by 2 B.A. cheese head, long, retaining timing case cover. (The eleven lowermost positions).....	11	11	...
012639	... Cover, inspection, for camshaft sprocket.....	1	1	...
000456	... Screw, $1\frac{1}{2}$ inch by 2 B.A. cheese head, retaining camshaft sprocket inspection cover.....	4	4	...
012637	... Cover, inspection, for magneto gear.....	1	1	...
012873	... Screw, $\frac{1}{2}$ inch by 2 B.A. cheese head, retaining magneto gear inspection cover.....	3	3	...
012179	... Pinion, timing, on timing side flywheel axle (30 teeth)...	1	1	...
000572	... Key, for timing pinion.....	2	2	...
013221	... Nut, retaining timing pinion ($\frac{5}{8}$ inch by 20 T.P.I. left hand thread)	1	1	...
012178	... Gear, half time.....	1	1	...
012214	... Shaft, for half time gear.....	1	1	...
000572	... Key, for half time gear.....	2	2	...

PART NUMBER	DESCRIPTION	QTY. OFF 49	QTY. OFF 50	Price on Application
012545	Bearing, for half time gear shaft (5).....	2	2	...
012180	Sprocket, for camshaft chain, on half time shaft.....	1	1	...
000572	Key, for half time sprocket.....	2	2	...
013217	Chain, driving, camshaft, 82 links, $\frac{3}{8}$ inch pitch, .225 inch wide. Manufacturer's Part Number 10038.....	1	1	...
013858	Locator, for camshaft chain (6).....	1	1	...
012751	Strip, fibre, rubbing, for camshaft chain.....	1	1	...
000112	Rivet, long, retaining rubbing strip in centre and upper positions.....	2	2	...
000111	Rivet, short, retaining rubbing strip in lowest position.....	1	1	...
012752	Blade, spring tension, for camshaft chain.....	1	1	...
012765	Bolt, anchor, for camshaft chain tension blade.....	1	1	...
012766	Washer, steel, plain, for tension blade anchor bolt.....	1	1	...
012753	Spring, spiral, for tension blade.....	1	1	...
012767	Pin, for tension blade spring.....	1	1	...
012754	Slider, for tension blade.....	1	1	...
012755	Spring, for tension blade slider.....	1	1	...
013851	Screw, $\frac{1}{2}$ inch by 2 B.A. cheese head, fixing slider spring, in uppermost position.....	1	1	...
000451	Screw, $\frac{1}{2}$ inch by 2 B.A. cheese head, fixing slider spring, in lowermost position.....	1	1	...
000190	Washer, plain, for slider spring fixing screws.....	2	2	...
013850	Wire, lock, for slider spring fixing screws.....	1	1	...
012178	Gear, intermediate. (Between half-time gear and magneto gear).....	1	1	...
012681	Shaft, for intermediate gear.....	1	1	...
015759	Shaft, for intermediate gear.....	1	1	...
000572	Key, for intermediate gear.....	2	2	...
012682	Bush, in crankcase, for intermediate gear shaft.....	1	1	...
015761	Bush, in crankcase, for intermediate gear shaft.....	1	1	...
012683	Bush, in oil pump support plate, for intermediate gear shaft.....	1	1	...
015760	Bush, in oil pump support plate, for intermediate gear shaft.....	1	1	...

NOTE 5.—Dimensions :—

Internal diameter $\frac{1}{2}$ inch.

External diameter $1\frac{1}{8}$ inch.

Thickness $\frac{3}{8}$ inch.

Manufacturer's Part Number is RLS-4.

One bearing is located in the timing side of crankcase and the other in the oil pump support plate.

NOTE 6.— This is retained to the oil pump support plate by the oil feed nozzle and 000073 nut.

OIL PUMPS AND OILING FITTINGS (Pipes are listed on page 34)

014905	Body, oil feed pump. (For $\frac{1}{8}$ inch gears).....	1	1	...
015598	Body, oil feed pump. (For $\frac{1}{8}$ inch gears).....	1	1	...
011557	Gear ($\frac{1}{8}$ inch wide), driving, oil feed pump.....	1	1	...
015570	Gear ($\frac{1}{8}$ inch wide), driving, oil feed pump.....	1	1	...
011558	Gear ($\frac{1}{8}$ inch wide), driven, oil feed pump.....	1	1	...
015574	Gear ($\frac{1}{8}$ inch wide), driven, oil feed pump.....	1	1	...
000007	Ball, steel, $\frac{1}{8}$ inch diameter, feed pump non-return valve.....	1	1	...
015227	Spring, feed pump non-return valve ball.....	1	1	...
011554	Plate, end, for oil feed pump.....	1	1	...
015576	Plate, end, front position, for oil feed pump.....	1	1	...
015575	Plate, end, back position, for oil feed pump.....	1	1	...
011556	Dowel, locating oil feed pump plates.....	2	2	...
013867	Washer, paper, for oil feed pump body.....	1	1	...
000453	Screw, 1 inch by 2 B.A. cheese head, retaining oil feed pump.....	3	3	...
011553	Body, oil scavenge pump. (For $\frac{3}{8}$ inch gears).....	1	1	...
015567	Body, oil scavenge pump. (For $\frac{3}{8}$ inch gears).....	1	1	...
011559	Gear ($\frac{3}{8}$ inch wide), driving, oil scavenge pump.....	1	1	...
015577	Gear ($\frac{3}{8}$ inch wide), driving, oil scavenge pump.....	1	1	...
011560	Gear ($\frac{3}{8}$ inch wide), driven, oil scavenge pump.....	1	1	...
015578	Gear ($\frac{3}{8}$ inch wide), driven, oil scavenge pump.....	1	1	...
011554	Plate, end, for oil scavenge pump.....	1	1	...
015576	Plate, end, front position, for oil scavenge pump.....	1	1	...
015573	Plate, end, back position, for oil scavenge pump.....	1	1	...

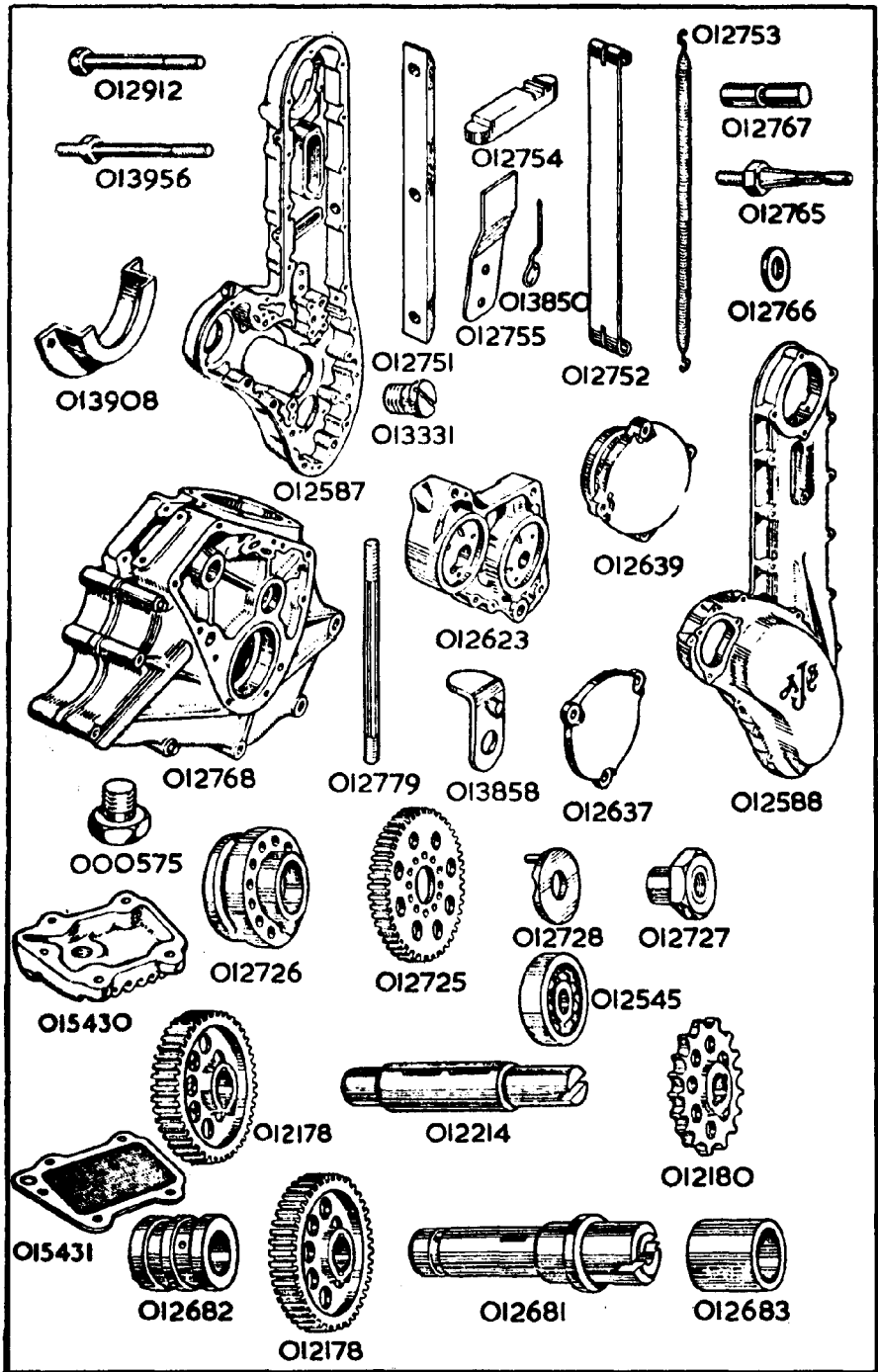

PART NUMBER	DESCRIPTION	QTY. OFF 49	QTY. OFF 50	Price on Application
015599	... Dowel, locating oil scavenge pump plates.....	-	2	...
011617	... Washer, paper, for oil scavenge pump body.....	1	1	...
014301	... Screw, 1 $\frac{3}{8}$ inch by 2 B.A. cheese head, retaining oil scavenge pump	3	3	...
012919	... Nozzle, oil feed to timing side flywheel axle (7).....	1	-	...
015812	... Nozzle, oil feed to timing side flywheel axle (7).....	-	1	...
000073	... Nut, retaining timing axle oil feed nozzle (7).....	1	1	...
012699	... Nozzle, oil feed to camshaft.....	1	1	...
012700	... Spring, for oil feed to camshaft nozzle	1	1	...
013327	... Union, for flexible oil pipes.....	2	1	...
016374	... Union, elbow, for flexible oil feed pipe.....	-	1	...
016375	... Nut, lock, for elbow union.....	-	1	...
013328	... Washer, fibre, for oil pipe unions.....	2	2	...
015989	... Plug, inspection, for front chain oil passage.....	-	1	...
016009	... Washer, fibre, for inspection plug.....	-	1	...
38-G3-E358	... Screw, needle adjusting, for front chain oil passage, screws into front left of crankcase.....	-	1	...
000290	... Nut, lock, for needle adjusting screw.....	-	1	...

NOTE 7 - Also retains camshaft chain locator 013858.

ROCKER BOX

012474	... Box, bare, for rockers.....	1	1	...
013092	... Ring, rubber, sealing, between rocker box and timing case	1	1	...
014086	... Shim, for rocker box (8).....	2	2	...
013932	... Shim, variable, for rocker box (9).....	2	2	...
012862	... Bolt, 1 $\frac{3}{8}$ inch by $\frac{1}{2}$ inch by 26, short, retaining rocker box	12	12	...
012871	... Bolt, 4 $\frac{1}{4}$ inches by $\frac{7}{8}$ inch by 22, long, retaining rocker box	4	4	...
000012	... Washer, plain, for rocker box short retaining bolt.....	12	12	...
012872	... Washer, plain, for rocker box long retaining bolt.....	4	4	...
012863	... Nut (trunnion), for rocker box short retaining bolts.....	12	12	...
012477	... Cover, for rocker box.....	2	2	...
014990	... Screw, $\frac{7}{8}$ inch by 2 B.A. hexagon head, retaining rocker box cover	11	11	...
012873	... Screw, $\frac{7}{8}$ inch by 2 B.A. cheese head, retaining rocker box cover	1	1	...
012549	... Rocker, operating valve (fitted with bush).....	2	2	...
012548	... Bush, for valve operating rocker.....	2	2	...
012677	... Spindle, for valve operating rocker	2	2	...
012731	... Ring, rubber, sealing, for valve rocker spindle.....	2	2	...
012737	... Stud, $\frac{3}{4}$ inch by $\frac{1}{2}$ inch by 26 by 20, clamping valve rocker spindle	2	2	...
012736	... Washer, lipped, for valve rocker spindle clamp.....	2	2	...
000005	... Nut, for valve rocker spindle clamping stud.....	2	2	...
014172	... Housing, with bush, for left hand end of camshaft (10)*...	1	1	...
012914	... Screw, $\frac{1}{2}$ inch by $\frac{1}{2}$ inch by 20, retaining camshaft bush and housing	4	4	...
012544	... Bearing, for right hand end of camshaft (11).....	1	1	...
013330	... Camshaft.....	1	1	...
012702	... Sleeve, on camshaft, for camshaft chain sprocket.....	1	1	...
000572	... Key, for camshaft sprocket sleeve.....	1	1	...
012701	... Sprocket, on camshaft sleeve, for camshaft chain.....	1	1	...
000230	... Nut, retaining camshaft chain sprocket to camshaft.....	1	1	...
012703	... Plate, with peg, driving, for camshaft sprocket and sleeve	1	1	...
000234	... Nut, retaining camshaft sprocket and peg plate to sleeve	1	1	...

NOTE 8.—This is the standard shim which provides correct adjustment of the camshaft driving chain when all parts are new.

NOTE 9.—This provides means of adjusting the tension of the camshaft driving chain after wear has taken place.

The shim is made up of laminations which may be peeled off as may be required to provide the correct degree of chain tension.

NOTE 10.—The plain bush for the camshaft is not sold separately.

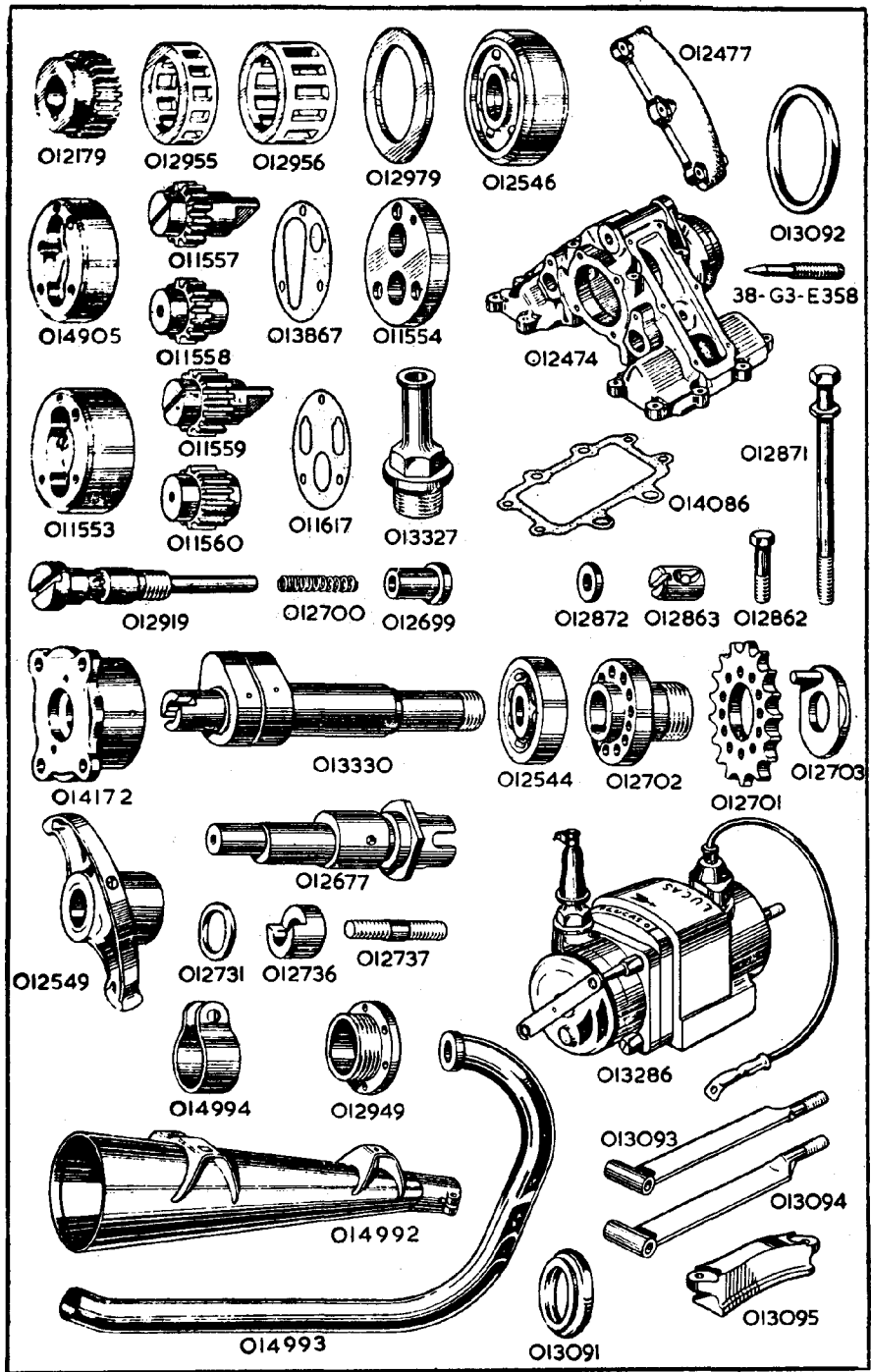

PART NUMBER	DESCRIPTION	QTY.	QTY.	Price on Application
		OFF 49	OFF 50	

NOTE 11.—Dimensions :—

Internal diameter $\frac{3}{8}$ inch.

External diameter $1\frac{1}{8}$ inch.

Thickness $\frac{7}{8}$ inch.

The Manufacturer's Part Number is RLS-5.

See page 3. for terms of service.

MAGNETO WITH DRIVE AND MOUNTING

013286	... Magneto, Type NRI, Lucas replacement number 42179-C, with high tension cable and terminal.....	1	...	-	...
016499	... Magneto, Type NTT-1, Lucas, with cable and terminal....	-	...	1	...
016500	... Magneto, Type MDI-AJS, B.T.H., with cable and terminal.....	-	...	1	...
013789	... Dowel, locating base of magneto.....	2	...	2	...
013091	... Strap, securing magneto, upper position.....	1	...	1	...
013094	... Strap, securing magneto, lower position.....	1	...	1	...
013096	... Bolt, $2\frac{1}{2}$ inch by $\frac{1}{2}$ inch by 20, retaining magneto strap to crankcase.....	2	...	2	...
000012	... Washer, plain, for magneto strap retaining bolt.....	2	...	2	...
013095	... Bridge, for magneto securing straps.....	1	...	1	...
000012	... Washer, plain, for magneto securing strap stud.....	2	...	2	...
000005	... Nut, for magneto securing strap stud.....	2	...	2	...
013091	... Ring, rubber, sealing, between magneto and timing case	1	...	-	...
015767	... Ring, rubber, sealing, between magneto and timing case	-	...	1	...
012726	... Sleeve, on magneto armature shaft.....	1	...	1	...
012725	... Gear, driving, on magneto armature shaft sleeve.....	1	...	1	...
012728	... Plate, with peg, driving, for magneto shaft sleeve.....	1	...	1	...
012727	... Nut, retaining sleeve to magneto armature shaft.....	1	...	1	...
014059	... Plug, sparking, Lodge Type RL-51.....	1	...	-	...
014554	... Plug, sparking, Lodge Type RL-49.....	1	...	-	...
015783	... Plug, sparking, K.L.G. Type KLG689-LR.....	-	...	1	...

* See page 3, for terms of service.



ALWAYS QUOTE

THE COMPLETE ENGINE NUMBER

(Including all the Letters in it).

THIS ENABLES US TO IDENTIFY THE MACHINE

EACH SERIES OF FRAMES IS NUMBERED FROM ZERO UPWARDS. THEREFORE THE QUOTATION OF A FRAME NUMBER ONLY DOES NOT PERMIT A MACHINE TO BE IDENTIFIED.

CARBURETTER SECTION

PART NUMBER	DESCRIPTION	QTY. OFF 49	QTY. OFF 50	Price on Applicator
COMPLETE CARBURETTER AND FIXING PARTS				
013704	... Carburetter, complete, Type 10T.T. (12)	1	1	...
013717	... Spacer, $\frac{3}{8}$ inch thick, between carburetter and cylinder head.....	1	1	...
014331	... Tube, supporting float chamber.....	1	1	...
000346	... Bolt, $1\frac{1}{8}$ inch by $\frac{1}{4}$ inch by 26, fixing float chamber support tube.....	2	2	...
014333	... Spacer, $1\frac{1}{2}$ inch long, for support tube bolt.....	2	2	...
014332	... Rubber, for support tube bolt.....	2	2	...
000012	... Washer, plain, for support tube bolt.....	2	2	...
000005	... Nut, for support tube bolt.....	2	2	...
013112	... Band, holding float chamber to support tube.....	1	1	...
013111	... Spacer, for float chamber band.....	1	1	...
013114	... Sleeve, for float chamber band.....	2	2	...
000350	... Bolt, $2\frac{1}{8}$ inches by $\frac{1}{4}$ inch by 26, clamping float chamber band	1	1	...
00639	... Spacer, $\frac{1}{4}$ inch long, for float chamber band bolt.....	2	2	...
000005	... Nut, for float chamber band bolt.....	1	1	...
000005	... Nut, lock, for float chamber band nut.....	1	1	...

*NOTE 12.—The price does not include :—
Control cables.
Twist grip.
Air control lever.
Carburetter support parts.*

FLOAT CHAMBER

302-3	... Chamber, float, complete (13).....	1	1	...
302-015	... Body, bare, float chamber.....	1	1	...
302-002	... Top (or cover), for float chamber (14).....	1	1	...
302-009	... Bolt, fixing float chamber top.....	2	2	...
302-010	... Tickler, bare.....	1	1	...
14-032	... Spring, for tickler.....	1	1	...
14-189	... Washer, fibre, for tickler.....	1	1	...
14-033	... Pin, split, for tickler.....	1	1	...
14-322-1	... Guide, for float, with bottom plug.....	1	1	...
14-252	... Washer, fibre, for bottom plug.....	1	1	...
302-004	... Float.....	1	1	...
14-320	... Needle, for float.....	1	1	...
14-219	... Connection, for hose to mixing chamber.....	1	1	...
14-336	... Washer, fibre, for hose connection.....	1	1	...
14-250	... Union, banjo, twin, for top of float chamber.....	1	1	...
14-275	... Washer, fibre, for twin banjo union.....	2	2	...
14-255	... Nut, retaining twin banjo union.....	1	1	...

NOTE 13.—Includes all items in this paragraph.

NOTE 14.—Includes the complete tickler.

HOSE, CONNECTING FLOAT AND MIXING CHAMBERS

013828	... Hose, connecting float and mixing chambers, $1\frac{1}{2}$ inch long	1	1	...
41-G3L-T97	... Wire, copper, for binding connection hose. (Five feet of 20 S.W.G. wire).....	1	1	...

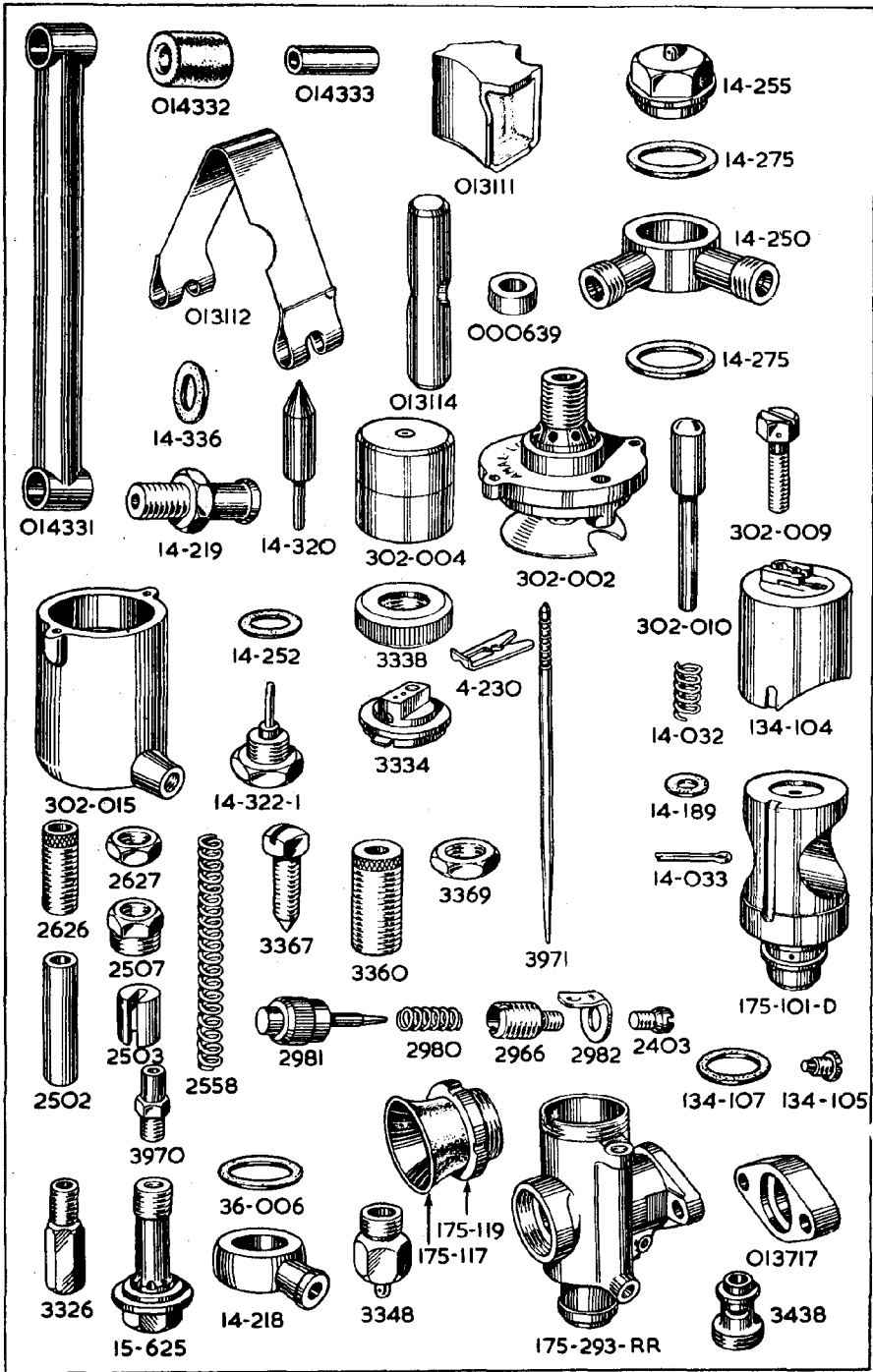

PART NUMBER	DESCRIPTION	QTY.	QTY.	Price on Application
		OFF 49	OFF 50	

MIXING CHAMBER

175-293-RR	Chamber, mixing, bare, 1 1/4 inch bore.....	
3334	Top, for mixing chamber (15).....	
3338	Ring, retaining mixing chamber top.....	
3366	Plunger, lock, for mixing chamber top.....	
3368	Pin, locating mixing chamber top lock plunger.....	
3367	Screw, adjusting lock plunger.....	
3360	Adjuster, for throttle cable.....	
3369	Nut, lock, for throttle cable adjuster.....	
175-101-D	Choke, 1 1/4 inch bore.....	
134-107	Washer, fibre, for choke.....	
3438	Tube, jet, for choke.....	
134-105	Screw, locating choke.....	
134-104	Valve, throttle, size 4.....	
2558	Spring, return, for throttle valve.....	
3971	Needle, taper, for jet.....	
4-230	Clip, retaining jet taper needle.....	
2502	Valve, air.....	
2558	Spring, return, air valve.....	
2503	Holder, for air valve cable nipple.....	
2507	Top, for air valve barrel.....	
2626	Adjuster, for air cable.....	
2627	Nut, lock, for air cable adjuster.....	
15-625	Holder, for jet (16).....	
3326	Jet, main, size 440 (17).....	
3970	Jet, needle, size 109 (18).....	
3348	Cap, for base of jet holder.....	
14-218	Connection, banjo, for hose from float chamber.....	
36-006	Washer, fibre, for banjo connection.....	2	...	2	...
2966	Holder, for pilot needle valve.....	
2981	Needle, pilot.....	
2982	Catch, lock, for pilot needle.....	
2980	Spring, for pilot needle.....	
2403	Screw, plug, for pilot needle fuel passage.....	
175-117	Intake, air.....	
175-119	Nut, lock, for air intake.....	

NOTE 15.—Includes the 3366 lock plunger and its 3368 locating pin.

NOTE 16. This also retains the choke and the 14-219 banjo connection.

NOTE 17.—When ordering a jet, always state the size required. It screws into the lower end of jet holder 15-625, and the standard size for jet or 440.

NOTE 18.—This screws into the upper end of jet holder 15-625.

Not sold as a separate spare, but is always included with 3334 top for mixing chamber.



EXHAUST PIPE AND MEGAPHONE SECTION

PART NUMBER	DESCRIPTION	QTY.	QTY.	Price on Application
		OFF 49	OFF 50	

EXHAUST PIPE

014993	Pipe, exhaust.....	
016147	Pipe, exhaust, with 012949 union nut (19).....	-
012949	Nut, union, for exhaust pipe.....	
014994	Clip, for exhaust pipe.....	

NOTE 19.—The union nut is assembled before the pipe is assembled and is then "non-detachable."

PART NUMBER	DESCRIPTION	QTY.	QTY.	Price on Application
		OFF 49	OFF 50	

MEGAPHONE

014992	... Megaphone, bare.....	1
016139	... Megaphone, bare.....	1	...	1
000368	... Bolt, 1 1/8 inch by 5/8 inch by 26, clamping megaphone to exhaust pipe.....	1	...	1
000011	... Washer, plain, for megaphone clamping bolt.....	1	...	1
000004	... Nut, megaphone clamping bolt.....	1	...	1
000371	... Bolt, 1 1/8 inch by 5/8 inch by 26, retaining megaphone to frame.....	1	...	1
000370	... Bolt, 1 3/8 inch by 5/8 inch by 26, retaining megaphone to frame.....	2
000174	... Washer, plain, megaphone retaining bolt.....	3	...	2
000004	... Nut, megaphone retaining bolt.....	3	...	1



TRANSMISSION SECTION

PART NUMBER	DESCRIPTION	QTY.	QTY.	Price on Application
		OFF 49	OFF 50	

ENGINE SPROCKETS AND SHOCK ABSORBER

015743	... Sprocket, engine, 18 teeth.....	-	...	1
013222	... Sprocket, engine, 19 teeth.....	1
015744	... Sprocket, engine, 19 teeth.....	-	...	1
014133	... Sprocket, engine, 20 teeth.....	1
015745	... Sprocket, engine, 20 teeth.....	-	...	1
013223	... Sprocket, engine, 21 teeth.....	1
015746	... Sprocket, engine, 21 teeth.....	-	...	1
013224	... Sprocket, engine, 22 teeth.....	1
015747	... Sprocket, engine, 22 teeth.....	-	...	1
013225	... Sprocket, engine, 23 teeth.....	1
010630	... Cam, engine shock absorber.....	1	...	1
000703	... Spring, engine shock absorber.....	1	...	1
000831	... Cap, engine shock absorber spring.....	1	...	1
013226	... Nut, lock, engine shock absorber.....	1	...	1
000051	... Nipple, grease, engine shock absorber lock nut.....	1	...	1

REAR WHEEL SPROCKETS

012526	... Sprocket, rear wheel, 54 teeth.....	1	...	1
012527	... Sprocket, rear wheel, 55 teeth.....	1	...	1
012528	... Sprocket, rear wheel, 56 teeth.....	1	...	1
012529	... Sprocket, rear wheel, 57 teeth.....	1	...	1
012530	... Sprocket, rear wheel, 58 teeth.....	1	...	1

For the sprocket fixing parts see "Rear Wheel" (page 37).

CHAINS

013218	... Chain, front, 64 links, 3/8 inch pitch by .305 inch wide. Manufacturer's Part Number 110046.....	1	...	1
013219	... Chain, rear, 110 links, 3/8 inch pitch by .255 inch wide. Manufacturer's Part Number 110054.....	1	...	1

PART NUMBER	DESCRIPTION	QTY.	QTY.	Price on Application
		OFF 49	OFF 50	

BOLTS FIXING GEAR BOX

012908	... Bolt, fixing top of gear box.....	1	-	...
015920	... Bolt, fixing top of gear box.....	-	1	...
000009	... Washer, plain, for gear box top fixing bolt.....	1	1	...
000166	... Washer, plain, thin, for gear box top fixing bolt.....	1	-	...
000002	... Nut, for gear box fixing bolt.....	1	1	...
012909	... Stud, 5 $\frac{3}{8}$ inch by $\frac{3}{8}$ inch by 26 by 26, fixing bottom of gear box.....	1	1	...
000010	... Washer, plain, for gear box bottom fixing stud.....	2	2	...
000003	... Nut, for gear box bottom fixing stud.....	2	2	...
013951	... Collar, $\frac{7}{16}$ inch long, for gear box bottom fixing stud.....	1	1	...
012671	... Adjuster (eye-bolt), for front chain adjustment.....	1	-	...
015974	... Adjuster (eye-bolt), for front chain adjustment.....	-	1	...
013950	... Nut, long, for front chain adjusting eye-bolt.....	1	-	...
000215	... Nut, short, for front chain adjusting eye-bolt.....	1	-	...
000004	... Nut, for front chain adjusting eye-bolt.....	-	2	...
000785	... Crosshead, for front chain adjusting eye-bolt.....	1	-	...
000361	... Bolt, $\frac{7}{16}$ inch by $\frac{7}{16}$ inch by 26, fixing crosshead to engine plate.....	1	-	...

GEAR BOX SHELL AND COVERS (1949 only)

4-948	... Shell, gear box, bare.....	1	-	...
1206-5	... Stud, gear box shell, $\frac{5}{16}$ inch diameter by 4 $\frac{3}{4}$ inches long	2	-	...
1206-1	... Stud, gear box shell, $\frac{1}{2}$ inch diameter by 4 $\frac{1}{4}$ inches long	2	-	...
116-H-1	... Stud, gear box shell, $\frac{1}{4}$ inch diameter by 1 $\frac{5}{8}$ inch long.....	2	-	...
2H-52-1	... Washer, spring, for $\frac{7}{16}$ inch diameter studs.....	2	-	...
OS-52-1	... Washer, spring, for $\frac{1}{2}$ inch diameter studs.....	4	-	...
152-X-1	... Nut, for $\frac{7}{16}$ inch diameter studs.....	2	-	...
63-X-1	... Nut, for $\frac{1}{2}$ inch diameter studs.....	4	-	...
348-X-1	... Plug, drain, for gear box shell.....	1	-	...
356-X-1	... Washer, fibre, for gear box shell drain plug.....	1	-	...
291-X	... Cap, in gear box shell, to seal selector spindle holes.....	2	-	...
182-X-1	... Cap, in gear box shell, to seal layshaft bearing holes.....	1	-	...
3-614	... Plate, end, for gear box shell.....	1	-	...
1206-2	... Stud, gear box end plate, $\frac{1}{4}$ inch diameter by 2 $\frac{1}{2}$ inches long	1	-	...
OS-52-1	... Washer, spring, for $\frac{1}{2}$ inch end plate stud.....	1	-	...
63-X-1	... Nut, for $\frac{1}{2}$ inch end plate stud.....	1	-	...
1203-3	... Washer, paper, between gear box shell and end plate...	1	-	...
4-950	... Cover, over gear change mechanism.....	1	-	...
326-X-1	... Cap, oil filler, for gear change cover.....	1	-	...
1-5724	... Plug, for oil level test.....	1	-	...
OG-85	... Washer, metal, for oil level test plug.....	1	-	...
OG-76	... Washer, rubber, for oil level test plug.....	1	-	...
1202-4	... Cap, in gear change cover, to seal camshaft hole.....	1	-	...
1203-6	... Washer, paper, between end plate and gear change cover	1	-	...

SHAFTS AND GEARS (1949 only)

1200-1	... Mainshaft, for gear box, 8 $\frac{7}{8}$ inches overall length.....	1	-	...
1200-3	... Gear, driving, on mainshaft, with bushes, 25 teeth.....	1	-	...
1204-1	... Gear, second, on mainshaft, 21 teeth.....	1	-	...
1204-2	... Gear, third, on mainshaft, 23 teeth.....	1	-	...
1204-3	... Gear, first, on mainshaft, 17 teeth.....	1	-	...
1200-2	... Layshaft.....	1	-	...
1204-6	... Gear, first, with bush, on layshaft, 29 teeth.....	1	-	...
1204-5	... Gear, second, with bush, on layshaft, 25 teeth.....	1	-	...
1204-7	... Gear, third, on layshaft, 23 teeth.....	1	-	...
1204-4	... Gear, small, on layshaft, 22 teeth.....	1	-	...

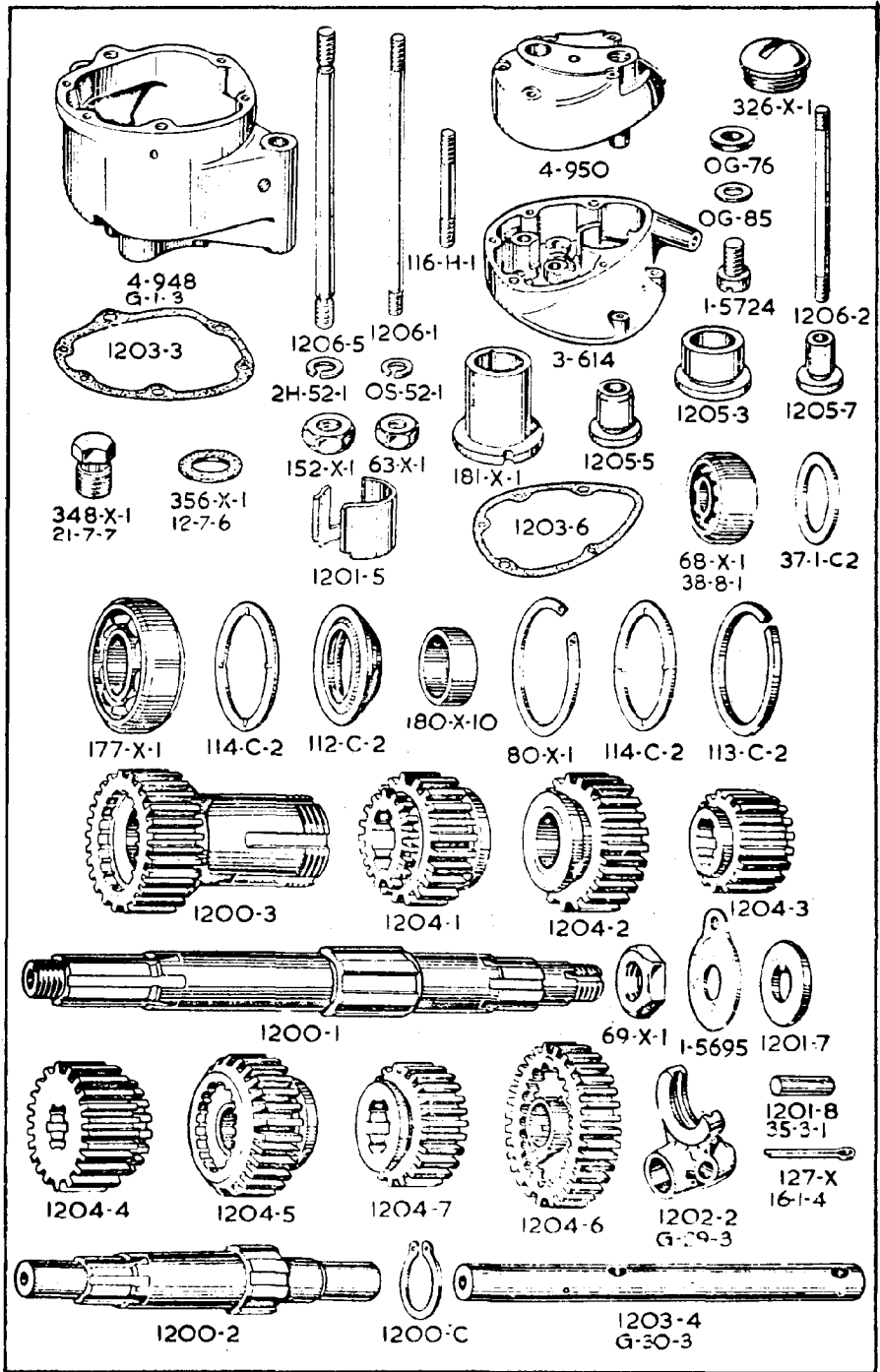

PART NUMBER	DESCRIPTION	QTY. OFF 49	QTY. OFF 50	Price on Application
GEAR BOX BEARINGS (1949 only)				
177-X-1	Bearing, ball, for driving gear, 1 $\frac{9}{32}$ inch by 62 mm. by 16 mm.	1	-	...
112-C-2	Seal, oil, for driving gear ball bearing	1	-	...
114-C-2	Washer, for each side of driving gear bearing oil seal	2	-	...
113-C-2	Ring, split, locating driving gear ball bearing	1	-	...
80-X-1	Ring, split, retaining driving gear ball bearing and oil seal assembly	1	-	...
68-X-1	Bearing, ball, for mainshaft, 17 mm. by 40 mm. by 12 mm.	1	-	...
37-1-C-2	Washer, plain, covering mainshaft ball bearing	1	-	...
1201-5	Ring, retaining mainshaft ball bearing	1	-	...
69-X-1	Nut, on mainshaft, retaining ball bearing	1	-	...
1201-7	Washer, lock, for mainshaft bearing retaining nut	1	-	...
181-X-1	Bush, in gear box shell, for layshaft	1	-	...
181-X-1	Bush, in end plate, for layshaft	1	-	...
87-X-1	Peg, locating layshaft bushes	2	-	...
1205-5	Bush, in end plate, for control spindle	1	-	...
1205-5	Bush, in end plate, for camshaft	1	-	...
1205-7	Bush, in gear change cover, for camshaft	1	-	...
1205-3	Bush, in gear change cover, for control spindle	1	-	...
187-X-3	Bush, for mainshaft driving gear	2	-	...
1203-7	Bush, for first gear on layshaft	1	-	...
1204-8	Bush, for second gear on layshaft	1	-	...
1204-8	Bush, for third gear on mainshaft	1	-	...

GEAR OPERATING PARTS (1949 only)

1203-4	Spindle, for gear change forks	2	-	...
1202-2	Fork, for gear change spindle	2	-	...
1201-8	Peg, retaining gear change fork to spindle	2	-	...
127-X	Pin, split, locking gear change fork retaining peg	2	-	...
1201-8	Peg, for fork spindle, engages in camshaft	2	-	...
127-X	Pin, split, locking fork spindle camshaft peg	2	-	...
3-615-ASS	Camshaft, assembly (20)	1	-	...
3-615	Cam, bare. Not sold separately, see Note (20)	1	-	...
1-5669	Peg, stop. Not sold separately, see Note (20)	2	-	...
1205-2	Spindle, cam. Not sold separately, see Note (20)	1	-	...
2525	Peg. Not sold separately, see Note (20)	1	-	...
1201-2	Quadrant, for gear control	1	-	...
1201-1	Spindle, for gear control quadrant	1	-	...
1211-5	Nut, retaining gear control quadrant	1	-	...
1206-8	Spring, for gear control quadrant and plunger carrier	1	-	...
1205-4	Carrier, for gear control plunger	1	-	...
1205-6	Plunger, for gear control carrier	1	-	...
1206-7	Spring, for gear control carrier plunger	1	-	...
1-5660	Plunger, for cam	1	-	...
1206-4	Spring, for cam plunger	1	-	...
1200-C	Carclip, locating gear control quadrant spindle	1	-	...

NOTE 20.—This assembly consists of :—
 One cam 3-615.
 Two stop pegs 1-5669.
 One spindle 1205-2.
 One peg 2525.

GEAR CONTROL PARTS (1949 only)

2-3234	Lever, foot, for gear change	1	-	...
CO-82-3	Pad, rubber, for gear change foot lever	1	-	...
CO-38	Pin, fixing gear change foot lever rubber pad	1	-	...
CO-63-3	Bolt, retaining gear change foot lever	1	-	...
OS-52-1	Washer, spring, for gear change foot lever bolt	1	-	...
10-X-1	Nut, for gear change foot lever retaining bolt	1	-	...

FINAL DRIVE (1949 only)

1202-3	Sprocket, final drive, 22 teeth, for $\frac{1}{2}$ inch by .225 chain	1	-	...
180-X-10	Collar, spacing, $\frac{1}{2}$ inch wide, for final drive	1	-	...
210-X-1	Washer, lock, for final drive sprocket nut	1	-	...
176-X-1	Nut, retaining final drive sprocket	1	-	...

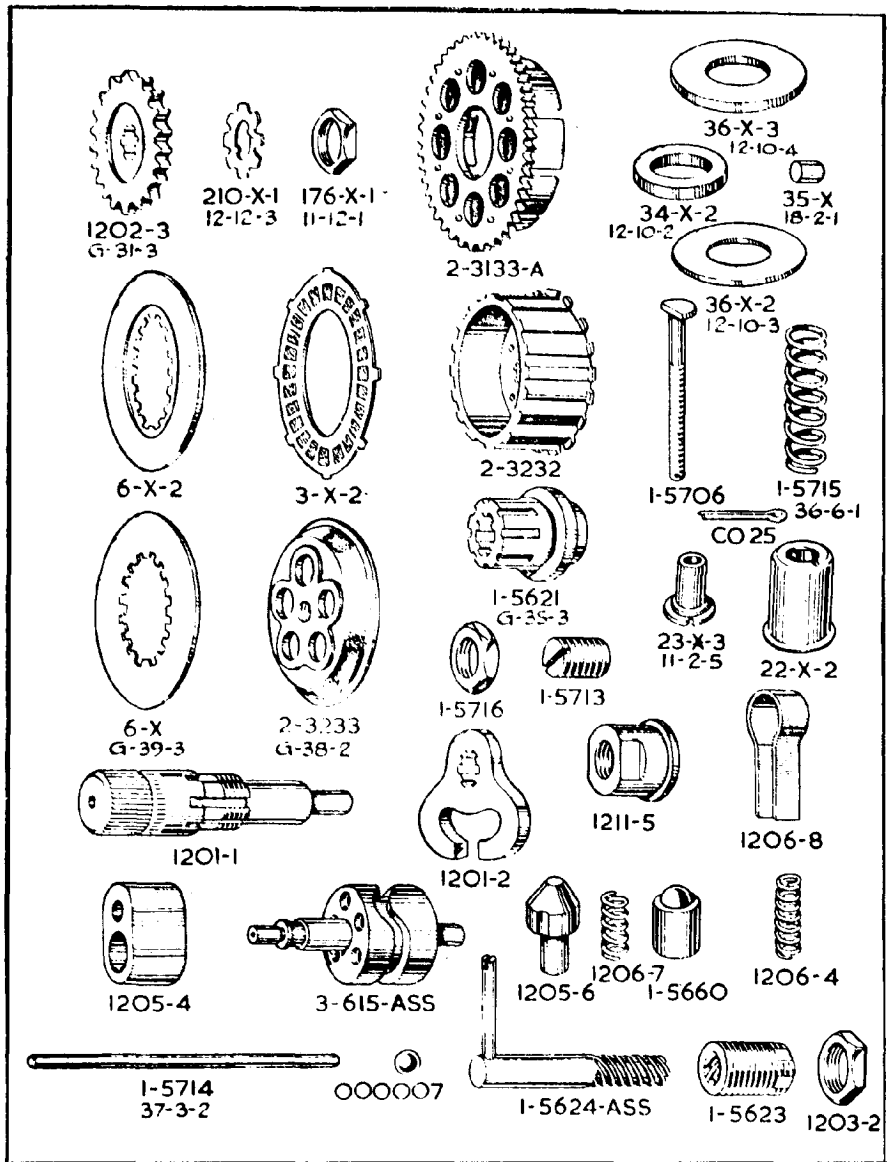

WHEN IN DOUBT REGARDING THE NAMES, AND PART
 NUMBERS OF THE PARTS YOU REQUIRE, PLEASE SEND
 THE OLD PARTS TO SERVE AS PATTERNS.

PART NUMBER	DESCRIPTION	QTY. OFF 49	QTY. OFF 50	Price on Application
-------------	-------------	-------------	-------------	----------------------

CLUTCH (1949 only)

2-3133	Chainwheel, clutch, bare, 44 teeth, for $\frac{1}{2}$ inch by -305 chain	1	-	-
1-X-10	Case, for clutch	1	-	-
OF-33	Rivet, fixing clutch case to chainwheel	8	-	-
2-3133-A	Chainwheel, assembly. (All above parts assembled)	1	-	-
2-3232	Centre, for clutch	1	-	-
1-5621	Sleeve, for clutch centre	1	-	-
69-X-1	Nut, retaining clutch centre sleeve to mainshaft	1	-	-
1-5695	Washer, locking clutch sleeve mainshaft retaining nut	1	-	-
34-X-2	Race, roller, for chainwheel bearing	1	-	-
36-X-2	Washer, thin, for chainwheel bearing	1	-	-
36-X-3	Washer, thick, for chainwheel bearing	1	-	-
35-X	Rollers, for chainwheel roller bearing	24	-	-
6-X	Plate, thin, plain, for clutch	6	-	-
3-X-2	Plate, friction, with inserts, for clutch	5	-	-
4-X-2	Insert, fibre, for clutch friction plate, price per dozen	120	-	-
2-3233	Plate, spring pressure, for clutch	1	-	-
1-5713	Cup, for centre of spring pressure plate	1	-	-
1-5716	Nut, lock, for spring pressure plate centre cup	1	-	-
1-5706	Stud, for clutch spring	5	-	-
22-X-2	Cup, for clutch spring	5	-	-
1-5715	Spring, for clutch	5	-	-
23-X-3	Nut, adjusting, for clutch spring	5	-	-
CO-25	Pin, split, locking clutch spring adjustment nut	5	-	-

CLUTCH OPERATING PARTS (1949 only)

1-5624-ASS	Worm, assembly (21)	1	-	-
1-5624	Worm, bare. Not sold separately, see Note (21)	1	-	-
1201-6	Lever. Not sold separately, see Note (21)	1	-	-
.093 by $\frac{1}{2}$	Pin, for lever. Not sold separately, see Note (21)	1	-	-
1-5623	Nut, worm, for operating worm	1	-	-
1203-2	Nut, locking worm nut	1	-	-
205-X-1	Cap, sealing end of worm nut	1	-	-
1-5714	Rod, thrust, for clutch. Two pieces each $\frac{5}{16}$ inch diameter by $4\frac{3}{4}$ inches long	2	-	-
000007	Ball, steel, $\frac{5}{16}$ inch diameter. (Located between the two clutch thrust rods)	1	-	-

NOTE 21.—This assembly comprises :—
 One worm 1-5624.
 One lever 1201-6.
 One pin .093 inch by $\frac{1}{2}$ inch.

GEAR BOX SHELL AND COVERS (1950 only)

G-1-3	Shell, gear box, bare	-	1	-
13-2-4	Stud, $2\frac{3}{4}$ inches by $\frac{1}{2}$ inch by 20 by 20	-	1	-
13-2-5	Stud, $2\frac{3}{4}$ inches by $\frac{3}{4}$ inch by 20 by 20	-	1	-
13-2-6	Stud, $3\frac{1}{2}$ inches by $\frac{1}{2}$ inch by 20 by 20	-	2	-
61-X	Stud, $1\frac{1}{2}$ inch by $\frac{3}{4}$ inch by 20 by 20	-	1	-
63-X	Nut, for $\frac{1}{2}$ inch by 20 stud	-	5	-
05-52	Washer, spring, for $\frac{1}{2}$ inch stud	-	5	-
247-X-2	Plug, oil filler and inspection	-	1	-
12-10-5	Washer, fibre, for inspection plug	-	1	-
21-7-7	Plug, oil level and drain	-	1	-
356-X	Washer, fibre, for oil level plug	-	1	-
21-8-1	Plug, oil, for layshaft housing	-	1	-
35-3-2	Dowel, for shell	-	1	-
291-X	Washer, covering selector fork spindle	-	2	-
28-12-19	Piece, locating	-	1	-
G-2-3	Plate, end, for gear box shell	-	1	-
G-5-6	Washer, paper, between shell and plate	-	1	-
13-2-7	Stud, $2\frac{3}{4}$ inches by $\frac{3}{4}$ inch by 20 by 20	-	2	-
11-2-4	Nut, for $\frac{1}{2}$ inch by 20 stud	-	2	-
12-2-1	Washer, spring, for $\frac{1}{2}$ inch stud	-	2	-
98-X	Plug, screw, in back of end plate	-	1	-

PART NUMBER	DESCRIPTION	QTY.	QTY.	Price on Application
		OFF 49	OFF 50	
G-3-3	Cover, over gear change mechanism.....	-	1	...
G-5-5	Washer, paper, between end plate and cover.....	-	1	...
21-7-7	Plug, oil level and drain.....	-	1	...
12-7-6	Washer, fibre, for oil level plug.....	-	1	...
247-Y-3	Plug, inspection.....	-	1	...
12-10-5	Washer, inspection plug.....	-	1	...
12-6-3	Washer, covering cam spindle.....	-	1	...

GEAR BOX BEARINGS (1950 only)

38-8-1	Bearing, ball, for mainshaft, $\frac{3}{4}$ inch by 47 mm. by 14 mm.	-	1	...
227-X	Ring, retaining bearing.....	-	1	...
38-12-1	Housing, outer, for driving gear bearing.....	-	1	...
10-1-5	Bolt, retaining bearing outer housing.....	-	5	...
12-5-5	Washer, tab, for outer housing bolt.....	-	5	...
38-12-2	Housing, inner, for driving gear bearing.....	-	1	...
18-2-2	Roller, $\frac{1}{4}$ inch by $\frac{1}{4}$ inch, for driving gear bearing and for layshaft bearing.....	-	106	...
12-12-4	Washer, spacing rollers on driving gear bearing.....	-	1	...
12-12-5	Washer, retaining rollers on driving gear bearing.....	-	1	...
27-12-3	Seal, oil, for driving gear bearing.....	-	1	...
223-X	Bush, for driving gear.....	-	2	...
20-8-10	Bush, for third gear on mainshaft.....	-	1	...
20-8-12	Bush, for first gear on layshaft.....	-	1	...
20-8-11	Bush, for second gear on layshaft.....	-	1	...
38-12-3	Housing, for layshaft rollers.....	-	2	...
38-8-2	Sleeve, for layshaft roller bearing.....	-	2	...
12-9-5	Washer, spacing, for layshaft roller bearing.....	-	2	...
25-10-1	Screw, adjuster, for layshaft.....	-	1	...
11-10-1	Nut, lock, for layshaft adjuster screw.....	-	1	...
12-10-6	Washer, lock, for layshaft adjuster screw nut.....	-	1	...
20-4-1	Bush, for cam spindles.....	-	2	...
20-8-9	Bush, outer, quadrant spindle.....	-	1	...
C0-91	Bush, outer, quadrant spindle.....	-	1	...

SHAFTS AND GEARS (1950 only)

G-18-3	Mainshaft, for gear box.....	-	1	...
G-6-3	Gear, driving, on mainshaft, with bushes, 25 teeth.....	-	1	...
G-10-3	Gear, second, on mainshaft, 21 teeth.....	-	1	...
G-8-2	Gear, third, with bushes, on mainshaft, 24 teeth.....	-	1	...
G-12-3	Gear, first, on mainshaft, 17 teeth.....	-	1	...
G-19-3	Layshaft.....	-	1	...
G-13-3	Gear, first, with bush, on layshaft, 28 teeth.....	-	1	...
G-11-3	Gear, second, with bush, on layshaft, 25 teeth.....	-	1	...
G-9-2	Gear, third, on layshaft, 23 teeth.....	-	1	...
G-7-3	Gear, small, on layshaft, 22 teeth.....	-	1	...
69-X-1	Nut, on mainshaft, foot change end.....	-	1	...
12-7-7	Washer, plain, for mainshaft nut.....	-	1	...
12-7-5	Washer, lock, for mainshaft nut.....	-	1	...

GEAR OPERATING PARTS (1950 only)

G-30-3	Spindle, for gear change forks.....	-	2	...
G-29-3	Fork, for gear change spindle.....	-	2	...
35-3-1	Peg, retaining gear change fork to spindle.....	-	2	...
127-X	Pin, split, locking gear change fork retaining peg.....	-	2	...
35-3-1	Peg, for fork spindle, engages in camshaft.....	-	2	...
127-X	Pin, split, locking, for spindle camshaft peg.....	-	2	...
C-27-2	Camshaft assembly.....	-	1	...
G-25-2	Quadrant, for gear control.....	-	1	...
G-24-2	Spindle, for gear control quadrant.....	-	1	...
35-2-5	Dowel, for gear control quadrant.....	-	1	...
G-42-3	Plunger, for camshaft.....	-	1	...
36-2-4	Spring, for camshaft plunger.....	-	1	...
36-11-21	Spring return (primary) (large U shape).....	-	1	...
36-8-3	Spring, return (secondary).....	-	1	...
35-3-3	Dowel, primary spring support.....	-	2	...

PART NUMBER	DESCRIPTION	QTY.	QTY.	Price on Application
		OFF 49	OFF 50	

GEAR CONTROL PARTS (1950 only)

G-44-3	Lever, foot, for gear change.....	-	1	...
G-48-1	Pad, rubber, for gear change foot lever.....	-	1	...
35-1-6	Pin, fixing gear change foot lever rubber pad.....	-	1	...
27-7-4	Seal, oil, for foot change lever.....	-	1	...
10-2-2	Bolt, retaining gear change foot lever.....	-	1	...
12-2-1	Washer, spring, for gear change foot-lever bolt.....	-	1	...
11-2-1	Nut, for gear change foot lever retaining bolt.....	-	1	...

FINAL DRIVE (1950 only)

G-31-3	Sprocket, final drive.....	-	1	...
28-12-25	Collar, spacing, for final sprocket.....	-	1	...
11-12-1	Nut, retaining final drive sprocket.....	-	1	...
12-12-3	Washer, lock, for final drive sprocket nut.....	-	1	...

CLUTCH (1950 only)

G-34-3	Chainwheel, clutch, bare.....	-	1	...
G-36-3	Case, for clutch.....	-	1	...
29-2-4	Rivet, fixing clutch case to chainwheel.....	-	8	...
G-34-3-A	Chainwheel, assembly. (All above parts assembled).....	-	1	...
G-37-4	Centre, for clutch.....	-	1	...
G-35-3	Sleeve, for clutch centre.....	-	1	...
11-7-11	Nut, retaining clutch centre sleeve to mainshaft.....	-	1	...
12-10-2	Race, roller, for chainwheel bearing.....	-	1	...
12-10-3	Washer, thin, for chainwheel bearing.....	-	1	...
12-10-4	Washer, thick, for chainwheel bearing.....	-	1	...
18-2-1	Roller, for chainwheel roller bearing, $\frac{1}{4}$ inch diameter, -236 inch long.....	-	24	...
G-39-2	Plate, plain, thick, for clutch.....	-	1	...
G-39-3	Plate, plain, thin, for clutch.....	-	5	...
G-40-4	Plate, friction, with inserts, for clutch.....	-	5	...
G-41-1	Insert, fibre, for clutch friction plate, price per dozen.....	-	120	...
G-38-2	Plate, spring pressure, for clutch.....	-	1	...
25-7-3	Cup, for centre of spring pressure plate.....	-	1	...
11-7-8	Nut, lock, for spring pressure plate centre cup.....	-	1	...
13-2-8	Stud, for clutch spring.....	-	5	...
G-42-2	Cup, for clutch spring.....	-	5	...
36-6-1	Spring, for clutch.....	-	5	...
11-2-5	Nut, adjusting, for clutch spring.....	-	5	...
11-2-1	Nut, lock, for clutch spring adjusting nut.....	-	5	...
G-46-1	Segment, clutch.....	-	10	...

CLUTCH OPERATING PARTS (1950 only)

37-3-2	Rod, thrust, for clutch, $\frac{1}{8}$ inch diameter, $10\frac{5}{8}$ inches long.....	-	1	...
G-33-1	Cam, adjusting, operating clutch.....	-	1	...
G-32-1	Cam, fixed, operating clutch.....	-	1	...
35-2-3	Dowel, for clutch case.....	-	1	...
16-1-5	Pin, split, for clutch cam dowel.....	-	1	...
12-2-4	Washer, for clutch cam.....	-	1	...
36-2-3	Spring, for clutch cam.....	-	1	...
35-1-1	Dowel, retaining clutch cam.....	-	1	...
17-3-2	Ball, steel, $\frac{1}{8}$ inch diameter, for clutch cam.....	-	4	...



BY USING GENUINE SPARES YOU ARE ASSURED THEY
WILL FIT ACCURATELY AND GIVE SATISFACTORY SERVICE

FRAME AND FORK SECTION

PART NUMBER	DESCRIPTION	QTY. OFF 49	QTY. OFF 50	Price on Application
MAIN FRAME				
012589	... Frame, main, bare.....	1	-	...
016420	... Frame, main, bare.....	-	1	...
012594	... Race, ball, in frame head, upper position.....	1	1	...
012595	... Race, ball, in frame head, lower position.....	1	1	...
000072	... Ball, steel, $\frac{3}{16}$ inch diameter, for steering ball races, per set 56	56	56	...
BOLTS FIXING ENGINE—IN FRONT				
012904	... Stud, engine fixing, front position.....	1	1	...
012668	... Spacer, $1\frac{7}{8}$ inch long, engine front fixing stud, left side....	1	1	...
012567	... Spacer, $2\frac{3}{8}$ inches long, engine front fixing stud, right side	1	1	...
000008	... Washer, plain, engine front fixing stud.....	2	2	...
000001	... Nut, engine front fixing stud.....	2	2	...
BOLTS AND PARTS FIXING ENGINE—AT TOP				
012621	... Plate, steady, between rocker box and main frame.....	2	2	...
000371	... Bolt, $1\frac{1}{8}$ inch by $\frac{5}{8}$ inch by 26, fixing steady plates to main frame	2	2	...
000011	... Washer, plain, for steady plate to frame fixing bolts.....	2	2	...
000004	... Nut, for steady plate to frame fixing bolts.....	2	2	...
000430	... Bolt, $3\frac{7}{8}$ inches long by $\frac{7}{8}$ inch by 26, fixing steady plates to rocker box	1	1	...
000009	... Washer, plain, for steady plate to rocker box bolt.....	1	1	...
014139	... Nut, for steady plate to rocker box bolt	1	1	...
014135	... Nut, lock, for steady plate to rocker box bolt nut.....	1	1	...
BOLTS AND PARTS FIXING ENGINE—AT REAR				
012630	... Plate, engine, rear.....	2	-	...
015977	... Plate, engine, rear, left side.....	-	1	...
015978	... Plate, engine, rear, right side.....	-	1	...
012910	... Stud, $4\frac{1}{8}$ inches long, $\frac{5}{8}$ inch diameter by 26 by 26, fixing engine at rear, top position.....	1	1	...
012910	... Stud, $4\frac{1}{8}$ inches long, $\frac{5}{8}$ inch diameter by 26 by 26, fixing engine at rear, centre position.....	1	1	...
012905	... Stud, $1\frac{1}{8}$ inches by $\frac{7}{8}$ inch by 26 by 26, fixing engine at rear, bottom position.....	1	-	...
015785	... Stud, $9\frac{1}{8}$ inches by $\frac{7}{8}$ inch by 26 by 26, fixing engine at rear, bottom position.....	-	1	...
012670	... Spacer, $1\frac{3}{4}$ inch long, on left side of engine fixing rear bottom stud	1	-	...
012669	... Spacer, $2\frac{1}{4}$ inches long, on right side of engine fixing rear bottom stud	1	-	...
000011	... Washer, plain, for $\frac{5}{8}$ inch engine studs.....	4	4	...
000009	... Washer, plain, for $\frac{7}{8}$ inch engine stud.....	2	-	...
000004	... Nut, for $\frac{5}{8}$ inch engine studs.....	4	4	...
000002	... Nut, for $\frac{7}{8}$ inch engine stud.....	2	-	...
015786	... Nut, Allen type, for $\frac{7}{8}$ inch engine stud.....	-	2	...
012640	... Plate, extension (on top of engine rear plate).....	1	-	...
016423	... Plate, extension (on top of engine rear plate).....	-	1	...
012906	... Stud, $11\frac{1}{2}$ inches by $\frac{1}{2}$ inch by 26 by 26, fixing rear of extension plate.....	1	1	...
012651	... Spacer, $5\frac{3}{8}$ inches long, for centre of extension plate rear bolt	1	-	...
012652	... Spacer, $1\frac{1}{2}$ inch long, for left side of extension plate rear bolt	1	-	...

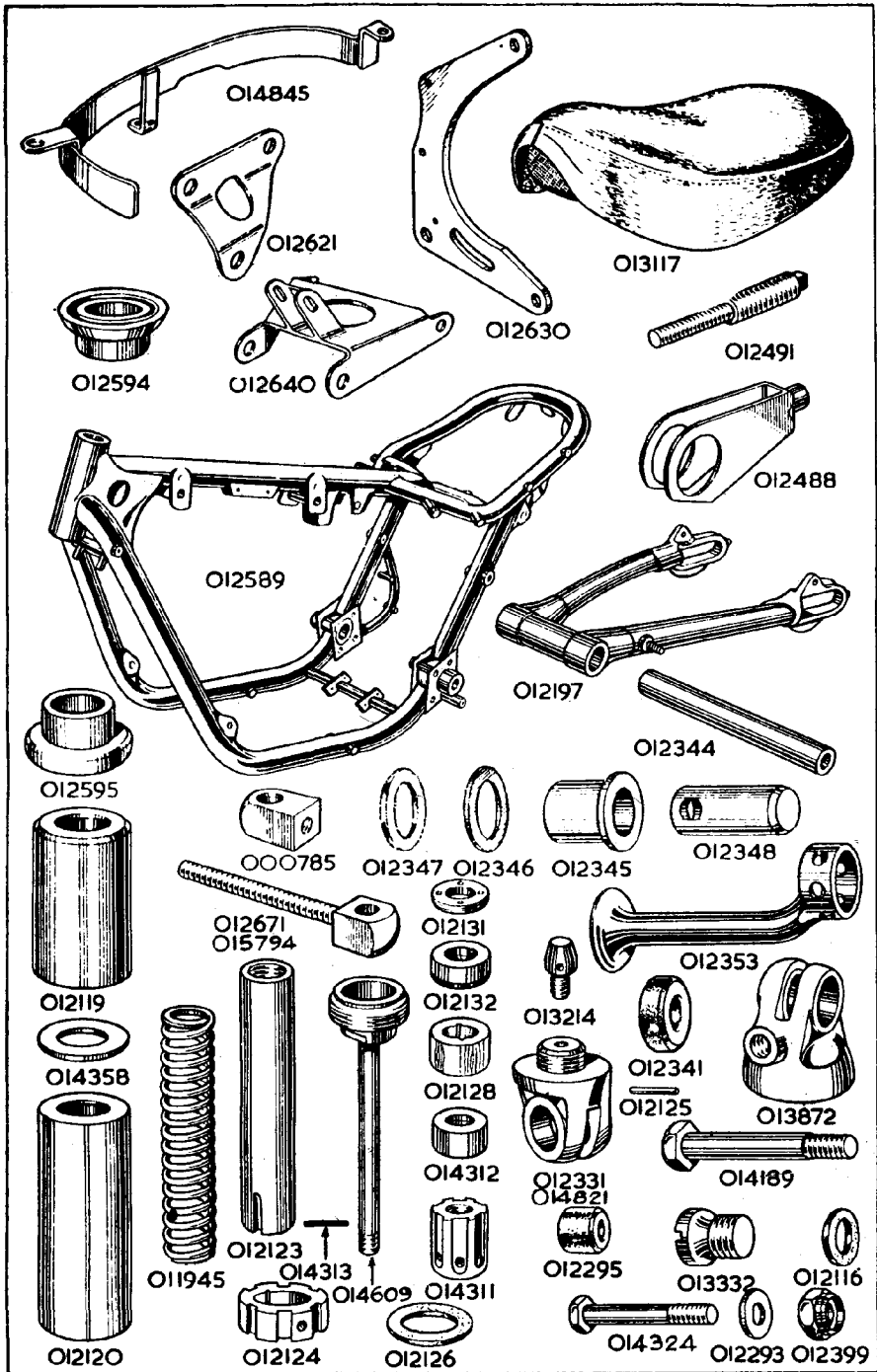

PART NUMBER	DESCRIPTION	QTY. OFF 49	QTY. OFF 50	Price on Application
000010	Washer, plain, for extension plate rear bolt.....	2	2	...
000003	Nut, for extension plate rear bolt.....	2	2	...
000363	Bolt, $\frac{3}{8}$ inch by $\frac{1}{8}$ inch by 26, fixing rear of engine rear plates at bottom.....	2	-	...
000365	Bolt, $1\frac{1}{8}$ inch by $\frac{5}{8}$ inch by 26, fixing rear of engine rear plates at bottom.....	-	2	...
000011	Washer, plain, for engine rear plate bottom bolts.....	2	2	...
000004	Nut, for engine rear plate bottom bolts.....	2	2	...

FORK CROWN, STEM, HANDLEBAR LUG AND HANDLEBAR

012182	Crown, front fork.....	1	1	...
41-18-FF20	Stem, front fork crown.....	1	1	...
40-G12M-FF92	Circlip, front fork crown stem.....	1	1	...
013556	Assembly, front fork crown and stem.....	1	1	...
000805	Race, ball, for fork crown.....	1	1	...
012272	Nut, adjusting, for fork crown stem.....	1	1	...
013355	Nut, lock, for fork crown stem adjusting nut.....	1	1	...
012266	Lug, for handlebar and steering head.....	1	-	...
016031	Lug, for handlebar and steering head.....	-	1	...
000051	Nipple, grease, for handlebar lug.....	1	1	...
012620	Race, ball, for handlebar lug.....	1	1	...
012274	Clip (half only), for handlebar lug.....	2	2	...
012275	Stud, $1\frac{1}{8}$ inch by $\frac{7}{8}$ inch by 22 by 26, for handlebar lug clip (front left position).....	1	1	...
013356	Stud, 2 inches by $\frac{7}{8}$ inch by 22 by 26, for handlebar lug clip (front right and both rear positions).....	3	3	...
000011	Washer, plain, for handlebar clip stud.....	4	4	...
000004	Nut, for handlebar clip stud.....	4	4	...
012473	Handlebar, bare.....	1	-	...
015829	Handlebar, bare.....	-	1	...

FORK TUBES, SPRINGS AND SLIDERS

012265	Tube, fork, inner.....	2	2	...
012260	Bolt, fixing inner tube to handlebar lug.....	2	2	...
012262	Ring, sealing (rubber), for inner tube top bolt.....	2	2	...
013361	Plate, under bolt fixing inner tube to lug.....	2	2	...
012263	Bolt, $2\frac{1}{4}$ inches by $\frac{3}{4}$ inch by 26, clamping inner tube in fork crown.....	2	2	...
000010	Washer, plain, for fork crown tube clamping bolt.....	4	4	...
000003	Nut, for fork crown tube clamping bolt.....	2	2	...
012247	Bush, plastic, for fork inner tube.....	2	-	...
015287	Bush, plastic, for fork inner tube.....	-	2	...
012248	Bush, steel, for fork inner tube.....	2	2	...
010867	Circlip, locating fork inner tube steel bush.....	2	2	...
012256	Spring, buffer, for front fork.....	2	2	...
012254	Spring, main, for front fork.....	2	2	...
012255	Washer, leather, for front fork spring.....	4	4	...
012259	Cup, locating leather washer, for lower end of main spring.....	2	2	...
012237	Slider, bare, for fork inner tube, left side (22).....	1	1	...
012238	Slider, bare, for fork inner tube, right side (22).....	1	1	...
012239	Cap, end, for fork slider (retaining wheel axle).....	2	2	...
012289	Stud, $1\frac{1}{2}$ inch by $\frac{1}{2}$ inch by 26 by 22, retaining fork slider end cap.....	4	4	...
000011	Washer, plain, for slider end cap stud.....	4	4	...
000004	Nut, for slider end cap stud.....	4	4	...
012240	Dowel, for slider end cap, locating wheel axle.....	2	2	...
000485	Screw, $\frac{3}{8}$ inch by $\frac{1}{4}$ inch by 26 with cheese head, oil drain, for slider.....	2	2	...
000203	Washer, fibre, for slider oil drain screw.....	2	2	...
014906	Seal, oil, for fork slider.....	2	2	...
012253	Washer, composition, sealing, for fork slider.....	2	2	...
012250	Extension, for fork slider.....	2	2	...
012257	Tube, cover, outer.....	2	2	...
012258	Cap, for top of outer cover tube.....	2	2	...

NOTE 22.—Does not include the end cap, studs, washers and nuts.

PART NUMBER	DESCRIPTION	QTY. OFF 49	QTY. OFF 50	Price on Application
-------------	-------------	-------------	-------------	----------------------

FORK SLIDER SUB ASSEMBLIES

012617	Slider, with two 012289 studs fitted, left side.....	1	1	...
012618	Slider, with two 012289 studs fitted, right side.....	1	1	...
012475	Slider, with end cap, studs, washers and nuts, fitted, left side	1	1	...
012476	Slider, with end cap, studs, washers and nuts, fitted, right side	1	1	...

FORK DAMPER

012245	Shuttle, for fork damper.....	2	2	...
012246	Circlip, locating damper shuttle.....	2	2	...
013646	Cone, damper, for bottom of slider.....	2	2	...
010697	Bolt, fixing damper cone to slider.....	2	2	...

STEERING DAMPER

012269	Plate, friction, for steering damper.....	1	1	...
000070	Bolt, $\frac{3}{8}$ inch by $\frac{1}{2}$ inch by 26, fixing plate to main frame	2	2	...
000012	Washer, plain, for plate fixing bolt.....	2	2	...
012271	Sleeve, with plate assembly, for steering damper.....	1	1	...
000070	Bolt, $\frac{3}{8}$ inch by $\frac{1}{2}$ inch by 26, fixing sleeve assembly to fork crown	1	1	...
000012	Washer, plain, for sleeve fixing bolt.....	1	1	...
000812	Washer, fibre, friction, for steering damper.....	2	2	...
012268	Bolt, centre draw, for steering damper.....	1	1	...
000195	Washer, double spring, fits under damper knob ratchet washer	1	1	...
000162	Washer, ratchet, fits under steering damper knob	1	1	...
12361	Knob, control, for steering damper.....	1	1	...

REVOLUTION COUNTER

014035	Counter, revolution, complete (23).....	1	1	...
016296	Counter, revolution, complete (23).....	1	1	...
013350	Bracket, for revolution counter head.....	1	1	...
013354	Spring, on head bracket, locking damper knob.....	1	1	...
016116	Spring, on head bracket, locking damper knob.....	1	1	...
000026	Rivet, retaining spring to counter head bracket.....	2	2	...
013351	Nut, sleeve, $\frac{1}{8}$ inch under hexagon head, threaded 0 B.A., fixing revolution counter head to bracket.....	2	2	...
013353	Grummet, rubber, for counter head fixing nut.....	4	4	...
013352	Washer, plain, for counter head fixing nut.....	4	4	...
41-G3L-T97	Wire, copper, for locking revolution counter head fixing nuts (five feet of 20 S.W.G. wire).....	1	1	...
000451	Screw, $\frac{1}{2}$ inch by 2 B.A. with cheese head, fixing revolution counter gear box to rocker box.....	2	2	...

NOTE 23.—Parts and Service for Revolution Counter must be obtained from Messrs. S. Smith & Sons (M.A.) Ltd., Cricklewood, London, N.W.

FRONT MUDGUARD

012369	Mudguard, front, bare.....	1	1	...
013375	Stay, top, for front mudguard.....	2	2	...
013875	Stud, $\frac{3}{32}$ inch long by $\frac{5}{16}$ inch by 26 and 22, fixing stay to left side fork slider.....	2	2	...
000192	Washer, spring, for top stay fixing stud.....	2	2	...
000004	Nut, for top stay fixing stud.....	2	2	...
41-G3L-M38	Bolt, $\frac{1}{2}$ inch by $\frac{5}{16}$ inch by 22, fixing stay to right side fork slider	2	2	...
000192	Washer, spring, for top stay fixing bolt.....	2	2	...
012565	Bolt, $\frac{1}{2}$ inch by 2 B.A., fixing front mudguard to top stay	6	6	...
000143	Washer, plain, for mudguard to top stay fixing bolt (2 used on each centre bolt).....	8	8	...
000080	Nut, for mudguard to top stay fixing bolt.....	6	6	...
012379	Stay, bottom, for front mudguard.....	1	1	...

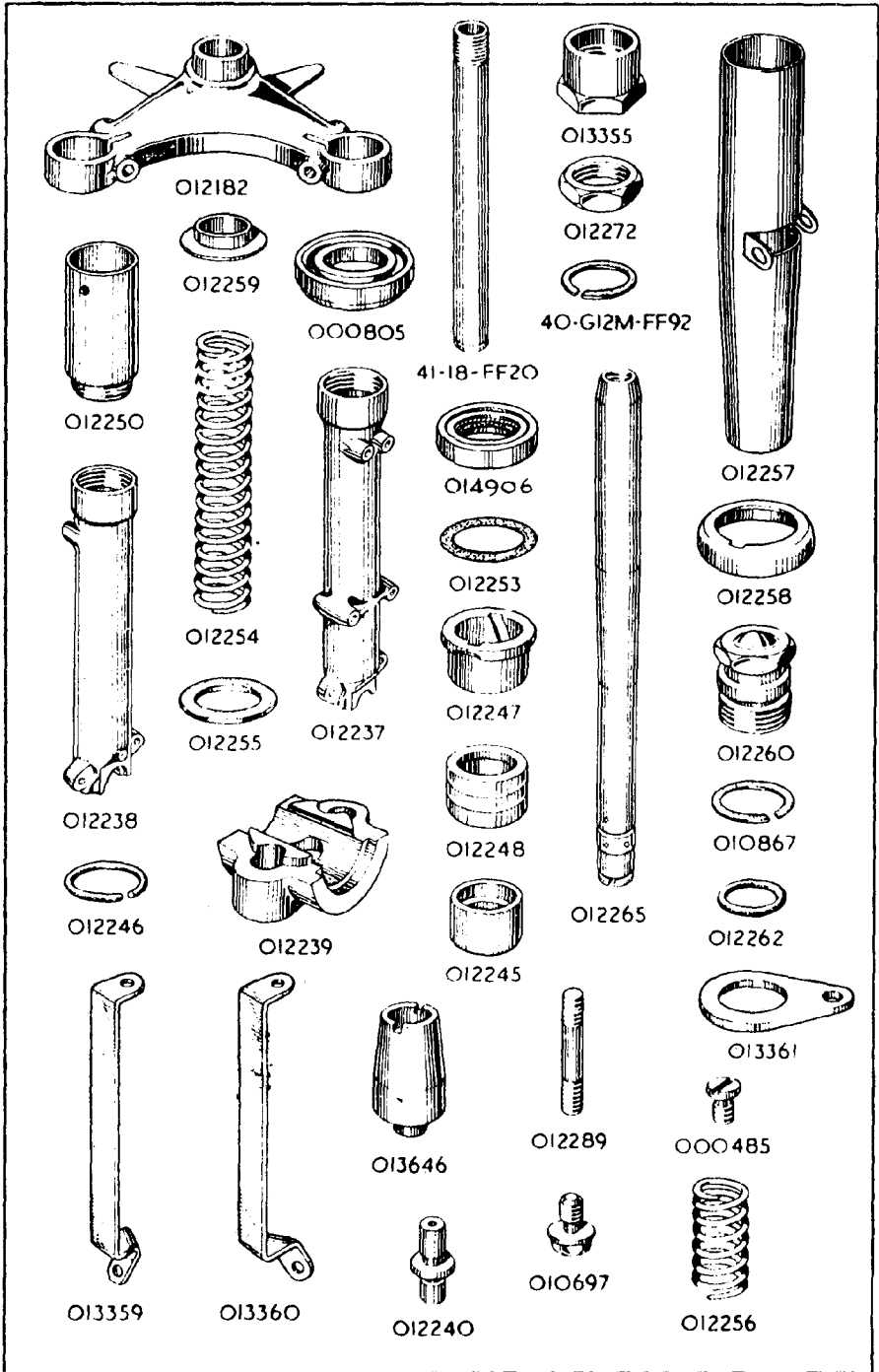

PART NUMBER	DESCRIPTION	QTY.	QTY.	Price on Application
		OFF 49	OFF 50	
41-G3L-M38...	Bolt, $\frac{1}{2}$ inch by $\frac{3}{8}$ inch by 22, fixing front mudguard stay to fork sliders.....	2	2	...
000192	Washer, spring, for mudguard stay to fork slider bolts.....	2	2	...
012565	Bolt, $\frac{1}{2}$ inch by 2 B.A., fixing front mudguard to bottom stay	4	4	...
000143	Washer, plain, for mudguard to bottom stay fixing bolt...	4	4	...
000080	Nut, for mudguard to bottom stay fixing bolt.....	4	4	...

REAR MUDGUARD

014093	Mudguard, rear, bare.....	1	1	...
014199	Stay, rear mudguard.....	1	1	...
014223	Tube, support, rear mudguard.....	1	1	...
014192	Bracket, top, for rear mudguard.....	1	-	...
013250	Bracket, bottom, for rear mudguard.....	1	-	...
000347	Bolt, $1\frac{1}{8}$ inch by $\frac{1}{2}$ inch by 26, fixing top bracket to frame	2	-	...
000012	Washer, plain, for top bracket fixing bolt.....	2	-	...
000005	Nut, for top bracket fixing bolt.....	2	-	...
000361	Bolt, $\frac{7}{8}$ inch by $\frac{3}{8}$ inch by 26, fixing bottom bracket to frame.....	2	-	...
000011	Washer, plain, for bottom bracket fixing bolt.....	2	-	...
000004	Nut, for bottom bracket fixing bolt.....	2	-	...
000343	Bolt, $1\frac{1}{4}$ inch by $\frac{1}{2}$ inch by 26, fixing rear mudguard.....	4	8	...
000342	Bolt, $1\frac{1}{4}$ inch by $\frac{1}{2}$ inch by 26, fixing rear mudguard (24)	9	5	...
011094	Grummet, rubber, for mudguard fixing bolt.....	13	13	...
000012	Washer, plain, for mudguard fixing bolt.....	26	34	...
014140	Spacer, for mudguard fixing bolt.....	13	13	...
000005	Nut, for mudguard fixing bolt.....	13	13	...

NOTE 24.—This bolt used on Rear lower position and on upper side of Front upper position.

CHAINGUARD

014845	Chainguard, for front driving chain.....	1	1	...
000004	Nut, fixing top of chainguard to crankcase bolt extension	1	1	...
000011	Washer, plain, for crankcase bolt extension nut.....	1	1	...

RACING PLATE BRACKET

013359	Bracket, left, for racing number plate.....	1	1	...
013360	Bracket, right, for racing number plate.....	1	1	...
000070	Bolt, $\frac{7}{8}$ inch by $\frac{1}{2}$ inch by 26, fixing racing number plate bracket at top.....	2	2	...
000012	Washer, plain, for plate bracket bolt.....	2	2	...
000005	Nut, for plate bracket bolt.....	2	2	...

REAR FORK

012197	Fork, rear, bare.....	1	1	...
012344	Tube, pivot, for rear fork.....	1	1	...
012345	Bush, for rear fork pivot tube.....	2	2	...
012348	Plug, for rear fork pivot tube.....	2	2	...
012346	Washer, metal, for rear fork pivot tube.....	2	2	...
012347	Washer, felt, for rear fork pivot tube.....	2	2	...
000054	Nipple, grease, for rear fork pivot.....	1	1	...

FOOTRESTS

012353	Arm, footrest.....	2	2	...
012851	Bolt, $2\frac{1}{4}$ inches by $\frac{3}{8}$ inch by 26, retaining footrest arm.....	2	2	...
012349	Washer, cupped, for footrest arm bolt.....	4	4	...
014119	Washer, lock, for footrest arm bolt.....	2	2	...
000003	Nut, for footrest arm bolt.....	2	2	...

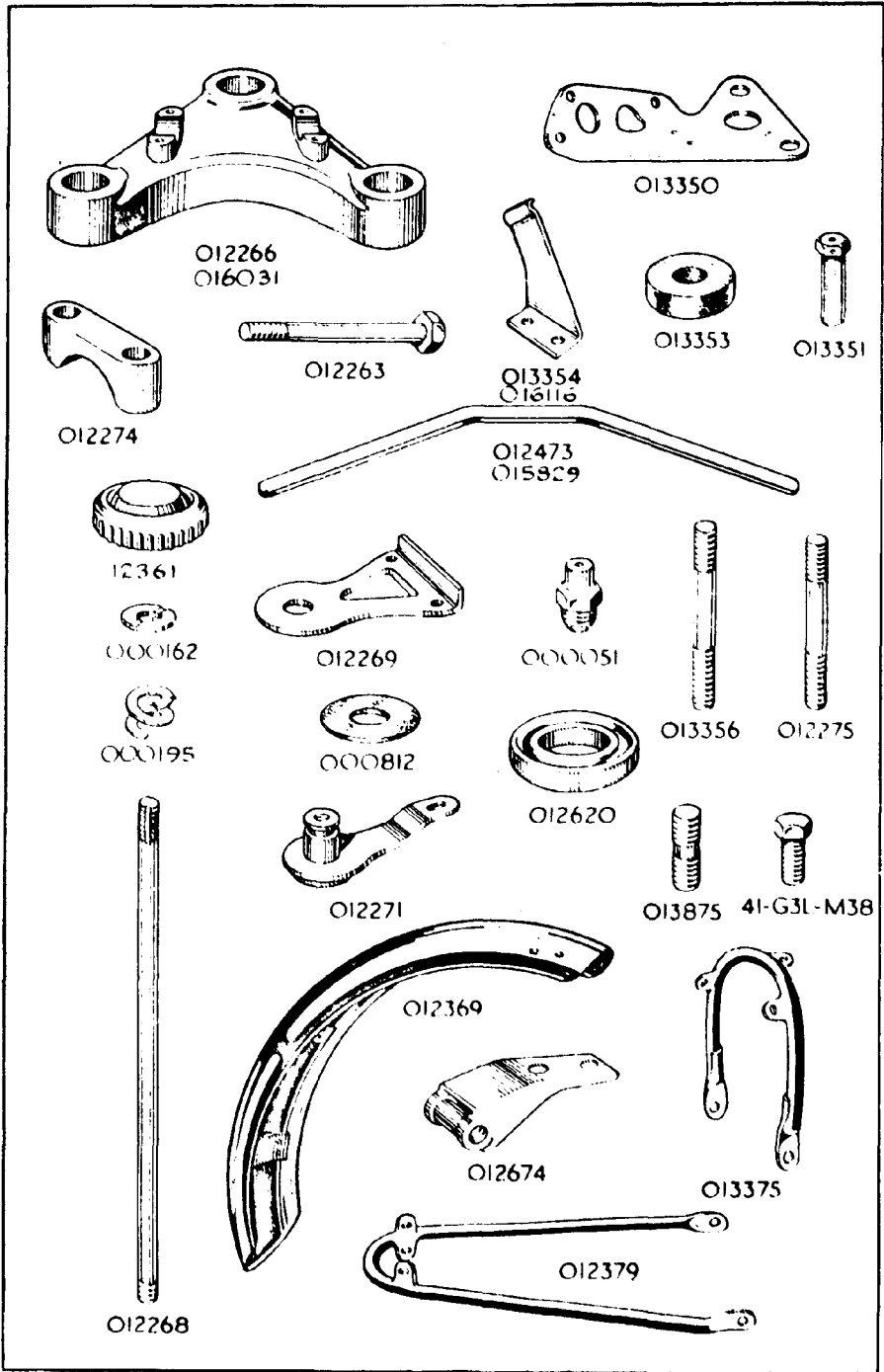

PART NUMBER	DESCRIPTION	QTY.	QTY.	Price on Application
		OFF 49	OFF 50	
REAR TELEDRAULIC LEGS				
014477	... Leg, Teledraulic, complete, assembled.....	2
016105	... Leg, Teledraulic, complete, assembled.....	-	...	2 ...
013872	... Pivot, top	2	...	2 ...
013332	... Plug, oil filling, for top pivot.....	2	...	2 ...
012116	... Washer, fibre, for top pivot oil filling plug.....	2	...	2 ...
014189	... Bolt, 2 $\frac{1}{2}$ inches by $\frac{3}{8}$ inch by 20, hinge for top pivot.....	2	...	2 ...
012295	... Spacer, $\frac{1}{2}$ inch long, for top pivot bolt.....	4	...	4 ...
012341	... Bush, rubber, for top pivot bolt.....	4	...	4 ...
012293	... Washer, plain, for top pivot bolt.....	4	...	4 ...
012399	... Nut, for top pivot bolt.....	2	...	2 ...
012331	... Pivot, bottom.....	2	...	- ...
014821	... Pivot, bottom.....	-	...	2 ...
014324	... Bolt, 1 $\frac{3}{8}$ inch by $\frac{3}{8}$ inch by 20, hinge, for bottom pivot.....	2	...	2 ...
012295	... Spacer, $\frac{1}{2}$ inch long, for bottom pivot bolt.....	4	...	4 ...
012341	... Bush, rubber, for bottom pivot bolt.....	4	...	4 ...
012293	... Washer, plain, for bottom pivot bolt.....	4	...	4 ...
012399	... Nut, for bottom pivot bolt.....	2	...	2 ...
011945	... Spring, suspension, for Teledraulic leg.....	2	...	2 ...
014358	... Spacer, $\frac{3}{8}$ inch thick, for suspension spring.....	2	...	2 ...
014609	... Tube, top, for damper.....	2	...	2 ...
015306	... Washer, " Fan Disc " for under-side of damper piston...	2	...	2 ...
014297	... Washer, composition, for damper top tube.....	2	...	2 ...
014311	... Piston, for damper top tube.....	2	...	- ...
014820	... Piston, for damper top tube.....	-	...	2 ...
014312	... Shuttle, for damper top tube.....	2	...	2 ...
014313	... Pin, locating, damper top tube shuttle.....	2	...	2 ...
012128	... Bush, plastic, for damper top tube.....	2	...	- ...
015701	... Bush, plastic, upper, for damper top tube.....	-	...	2 ...
015702	... Bush, plastic, upper, for damper top tube.....	-	...	2 ...
015703	... Ring, sealing, between damper tube plastic bushes.....	-	...	2 ...
012132	... Seal, oil, for damper top tube.....	2	...	2 ...
012131	... Cap, screwed, on top of oil-seal.....	2	...	2 ...
012123	... Tube, bottom, for damper.....	2	...	2 ...
012126	... Washer, fibre, under damper bottom tube.....	2	...	2 ...
012124	... Ring, for damper bottom tube.....	2	...	2 ...
012125	... Dowel, locating damper bottom tube nut.....	2	...	2 ...
013214	... Cone, buffer, for damper.....	2	...	- ...
012119	... Tube, cover, top position, for Teledraulic leg.....	2	...	2 ...
012120	... Tube, cover, bottom position, for Teledraulic leg.....	2	...	2 ...

SEAT

013117	... Seat	1	...	1 ...
000451	... Screw, $\frac{1}{2}$ inch by 2 B.A., with cheese head, fixing seat.....	10	...	10 ...
000143	... Washer, plain, for seat fixing screw.....	10	...	10 ...



GENUINE "A·J·S" SPARES

PURCHASED FROM
 AN AUTHORISED "A·J·S" DEALER OR
 FROM THE FACTORY, ARE IDENTICAL
 WITH THE PARTS ORIGINALLY BUILT
 INTO YOUR MOTOR CYCLE.

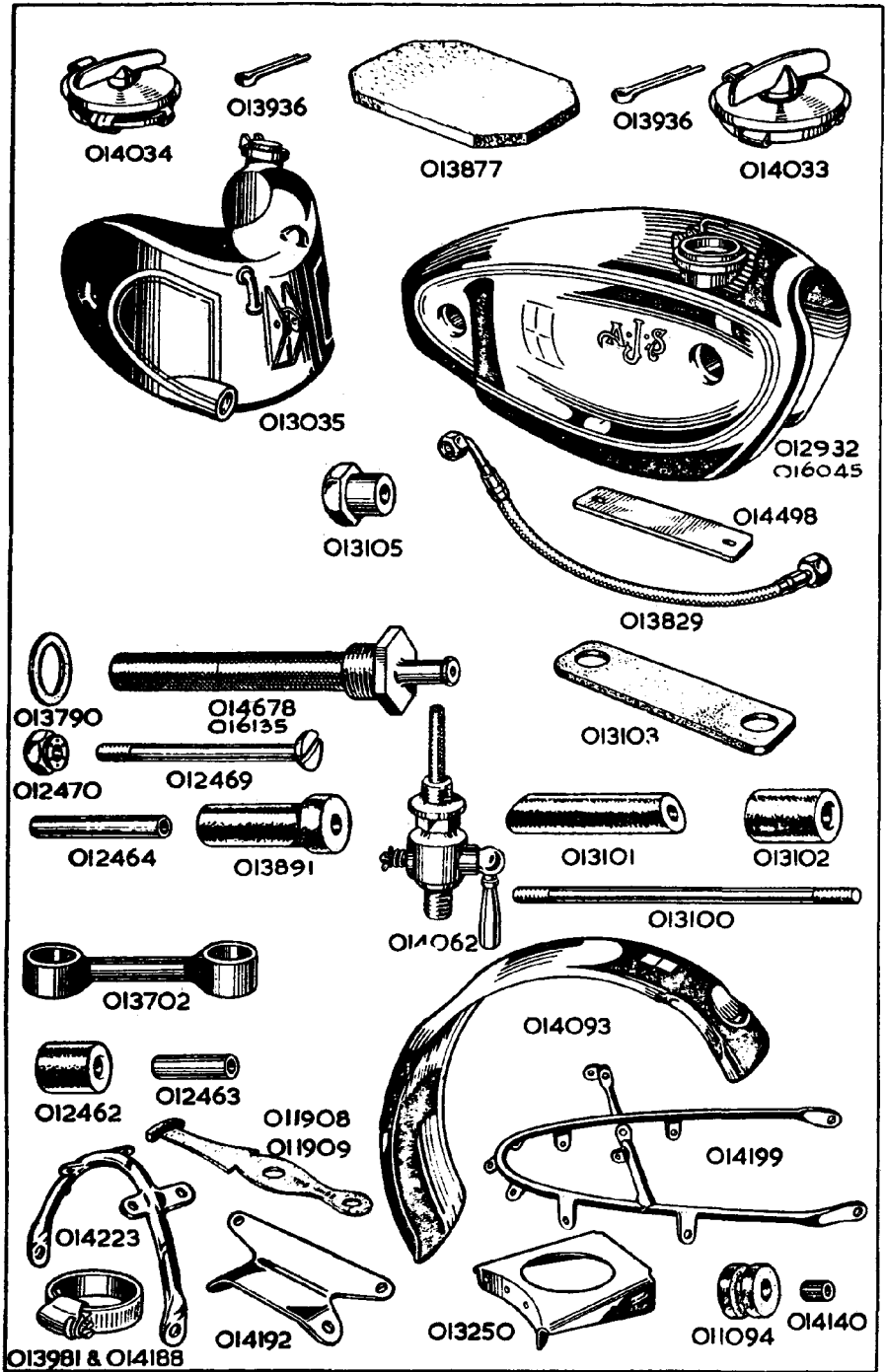

TANK SECTION

PART NUMBER	DESCRIPTION	QTY. OFF 49	QTY. OFF 50	Price on Application
----------------	-------------	-------------------	-------------------	----------------------------

FUEL TANK

012932	... Tank, fuel, bare.....	1	...	-	...
016045	... Tank, fuel, bare.....	-	...	1	...
014033	... Cap, filler, for fuel tank.....	1	...	-	...
013936	... Pin, hinge, for fuel tank filler cap.....	1	...	-	...
016044	... Cap, filler, for fuel tank.....	-	...	1	...
016047	... Pin, hinge, for fuel tank filler cap.....	-	...	1	...
016157	... Nut, for hinge pin.....	-	...	1	...
016158	... Catch, for fuel tank filler cap.....	-	...	1	...
016159	... Pin, hinge, for filler cap catch.....	-	...	1	...
016160	... Spring, for filler cap catch.....	-	...	1	...
016157	... Nut, for filler cap catch hinge pin.....	-	...	1	...
013877	... Pad, chin, for fuel tank.....	1	...	1	...
014062	... Tap, with filter, for fuel feed.....	2	...	2	...
000183	... Washer, fibre, for fuel feed tap filter.....	2	...	2	...

FUEL TANK FIXING PARTS

013100	... Stud, fixing fuel tank to main frame.....	2	...	2	...
013101	... Rubber, inner, for fuel tank fixing stud.....	2	...	2	...
013102	... Rubber, outer, for fuel tank fixing stud.....	4	...	4	...
000174	... Washer, plain, for fuel tank fixing stud.....	4	...	4	...
013105	... Nut, for fuel tank fixing stud.....	4	...	4	...
013103	... Pad, strip, rubber, seating on top tube for fuel tank.....	2	...	2	...
013891	... Stop, moulded, to seal fuel tank fixing stud sockets.....	4	...	4	...
014498	... Stay, for fuel tank.....	1	...	1	...
000341	... Bolt, $\frac{1}{2}$ inch by $\frac{1}{2}$ inch by 20, fixing fuel tank stay.....	2	...	2	...
000012	... Washer, plain, for fuel tank stay fixing bolt.....	2	...	2	...

FUEL PIPING

013829	... Hose, for fuel feed from tank to float chamber.....	2	...	2	...
013830	... Hose, for vent pipe on fuel tank (22 inches long).....	1	...	1	...
41-G3L-T97	... Wire, copper, for binding fuel feed hoses (five feet 20 S.W.G. wire).....	1	...	1	...

OIL TANK

013035	... Tank, oil, bare.....	1	...	-	...
016015	... Tank, oil, bare.....	-	...	1	...
014034	... Cap, filler, for oil tank.....	1	...	-	...
013936	... Pin, hinge, for oil tank filler cap.....	1	...	-	...
016023	... Cap, filler, for oil tank.....	-	...	1	...
016024	... Pin, hinge, for oil tank filler cap.....	-	...	1	...
016157	... Nut, for hinge pin.....	-	...	1	...
016161	... Catch, for oil tank filler cap.....	-	...	1	...
016162	... Pin, hinge, for filler cap catch.....	-	...	1	...
016160	... Spring, for filler cap catch.....	-	...	1	...
016157	... Nut for filler cap catch hinge pin.....	-	...	1	...
014678	... Filter, assembled on union, for oil feed.....	1	...	-	...
016035	... Filter, assembled on union, for oil feed.....	-	...	1	...
013790	... Washer, fibre, for oil feed union.....	1	...	-	...
014749	... Plug, drain, for oil tank.....	1	...	-	...

PART NUMBER	DESCRIPTION	QTY.	QTY.	Price on Application
		OFF 49	OFF 50	

OIL TANK FIXING PARTS

012469	Bolt, 4 $\frac{1}{8}$ inches by $\frac{1}{8}$ inch by 22, fixing oil tank at sides	2	—	—
016026	Bolt, 2 $\frac{3}{8}$ inches by $\frac{3}{8}$ inch by 22, fixing oil tank at sides	—	2	—
012464	Spacer, 2 $\frac{3}{8}$ inches long, for oil tank side fixing bolt	2	—	—
016027	Spacer, 1 $\frac{3}{8}$ inch long, for oil tank side fixing bolt	—	2	—
013104	Grummet, rubber, for oil tank side fixing bolt	2	—	—
016025	Grummet, rubber, for oil tank side fixing bolt	—	4	—
000011	Washer, plain, for oil tank side fixing bolt	2	—	—
000174	Washer, plain, for oil tank side fixing bolt	—	2	—
012470	Nut, for oil tank side fixing bolt	2	—	2
013702	Link, suspension, for oil tank top fixing	1	—	1
000346	Bolt, 1 $\frac{7}{8}$ inch by $\frac{1}{4}$ inch by 26, fixing suspension link, upper position	1	—	1
000347	Bolt, 1 $\frac{5}{8}$ inch by $\frac{1}{4}$ inch by 26, fixing suspension link, lower position	1	—	1
012463	Spacer, 1 inch long, for suspension link fixing bolt	2	—	2
012462	Grummet, rubber, for suspension link fixing bolt	2	—	2
000012	Washer, plain, for suspension link fixing bolt	2	—	2
000005	Nut, for suspension link fixing bolt	2	—	2

OIL PIPING

013831	Hose, oil feed (two pieces used, each 2 $\frac{1}{2}$ inches). Price per set of two pieces	2	—	—
016107	Hose, oil feed, 4 inches long	—	1	—
014109	Pipe, metal, connecting the two feed hoses	1	—	—
014188	Clip, retaining oil feed hose	4	—	2
014848	Hose, oil return, long, 11 inches long	1	—	1
014849	Hose, oil return, short, 2 $\frac{1}{2}$ inches long	1	—	1
014938	T piece, for chain oiler (inserted between the two oil return hoses)	1	—	1
38-G3-E358	Screw, needle adjusting, for chain oiler T piece	1	—	1
000290	Nut, lock, for needle screw in chain oiler T piece	1	—	1
014188	Clip, retaining oil return hoses	4	—	4
014847	Hose, for chain oiling, 13 inches long	1	—	—
016108	Hose, for chain oiling, 10 inches long	—	1	—
013981	Clip, for binding chain oiling hose to T piece	1	—	1
014844	Clip, for middle of chain oiling hose (fixes to crankcase bolt)	1	—	—
013968	Clip, for chain end of chain oiling hose	1	—	1
000451	Screw, $\frac{3}{8}$ inch by 2 B.A., with cheese head, binding chain oiling hose chain end clip	1	—	1
000080	Nut, for chain oiling hose chain end clip screw	1	—	1
013833	Hose, air vent, for oil tank, 27 inches long	1	—	1
014188	Clip, retaining air vent hose to oil tank nipple	1	—	1
011908	Clip, rubber, retaining free end of air vent hose	2	—	2



For the convenience of Owners, **SPARES STOCKISTS** are appointed for most districts. To save delay, and the delivery surcharge customers are recommended to always first apply to their nearest Agent or spares stockist.

WHEEL AND BRAKE SECTION

PART NUMBER	DESCRIPTION	QTY. OFF 49	QTY. OFF 50	Price on Application
FRONT WHEEL				
012690	... Wheel, front, assembly, steel rim (25).....	1	-	...
016501	... Wheel, front, assembly, steel rim (25).....	-	...	1
016502	... Wheel, front, assembly, alloy rim (25).....	1	-	...
016182	... Wheel, front, assembly, alloy rim (25).....	-	...	1
016503	... Wheel, front, bare, steel rim (26).....	1	-	...
016184	... Wheel, front, bare, steel rim (26).....	-	...	1
016504	... Wheel, front, bare, alloy rim (26).....	1	-	...
016183	... Wheel, front, bare, alloy rim (26).....	-	...	1
012355	... Hub, front, with brake liner (27)	1	-	...
016505	... Hub, front, with brake liner (27)	-	...	1
016249	... Screw, 1 inch by $\frac{1}{2}$ inch by 20 ("UNBRAKO") retain- ing brake liner in hub	-	...	6
016396	... Nut, for brake liner retaining screw.....	-	...	6
012687	... Rim, front wheel, steel.....	1	-	...
012450	... Rim, front wheel, alloy.....	1	-	...
012437	... Spoke, front wheel, right side.....	20	-	20
012438	... Spoke, front wheel, left side.....	20	-	...
016099	... Spoke, front wheel, left side.....	-	...	20
011017	... Nipple, front wheel spoke.....	40	-	40
013978	... Washer, for spoke nipple (only used with alloy rim).....	40	-	40
014031	... Bolt, security, for front tyre, alloy rim.....	2	-	2
016185	... Bolt, security, for front tyre, steel rim.....	2	-	2
012485	... Cover, for right of front hub.....	1	-	...
012498	... Stud, head $\frac{3}{8}$ inch long, $\frac{11}{16}$ inch under head by $\frac{3}{16}$ inch by 24, for fixing front hub cover	3	-	3
000861	... Screw, $\frac{5}{16}$ inch by 2 B.A., fixing front hub cover to fixing stud	3	-	3
012540	... Bearing, ball, for front hub (28)	1	-	...
012541	... Bearing, roller, for front hub (29).....	1	-	...
012515	... Spacer, 2 $\frac{3}{4}$ inches long, between front hub bearings	1	-	...
012443	... Seal, oil, for front hub bearings.....	2	-	...
012510	... Washer, cupped, for front hub bearing.....	2	-	2
012512	... Washer, slightly dished, for front hub bearing	2	-	2
014308	... Circlip, locating front hub bearings.....	1	-	...
012506	... Ring, locating front hub bearings.....	1	-	...
012504	... Nut, locking bearing locating ring in front hub.....	1	-	...
012445	... Spindle, for front wheel.....	1	-	...
012499	... Nut, for front wheel spindle.....	1	-	...
012520	... Spacer, $\frac{5}{8}$ inch long, on front wheel spindle.....	1	-	...
015813	... Spacer, $\frac{5}{16}$ inch long with central flange, on front wheel spindle	-	...	1

NOTE 25.—Comprises hub, rim, spokes, and nipples, built up with bearings assembled.

NOTE 26.—Comprises hub, rim, spokes and nipples built up.

NOTE 27.—Brake liner is not supplied as a spare, return wheel to Factory when new liner required.

NOTE 28.—Dimensions :—

Internal diameter $\frac{3}{4}$ inch.

External diameter $1\frac{7}{11}$ inch.

Thickness $\frac{9}{16}$ inch.

Manufacturer's Part Number is RLS-6.

NOTE 29.—Dimensions :—

Internal diameter $\frac{3}{4}$ inch.

External diameter $1\frac{1}{8}$ inch.

Thickness $\frac{9}{16}$ inch.

Manufacturer's Part Number is CRL-6.

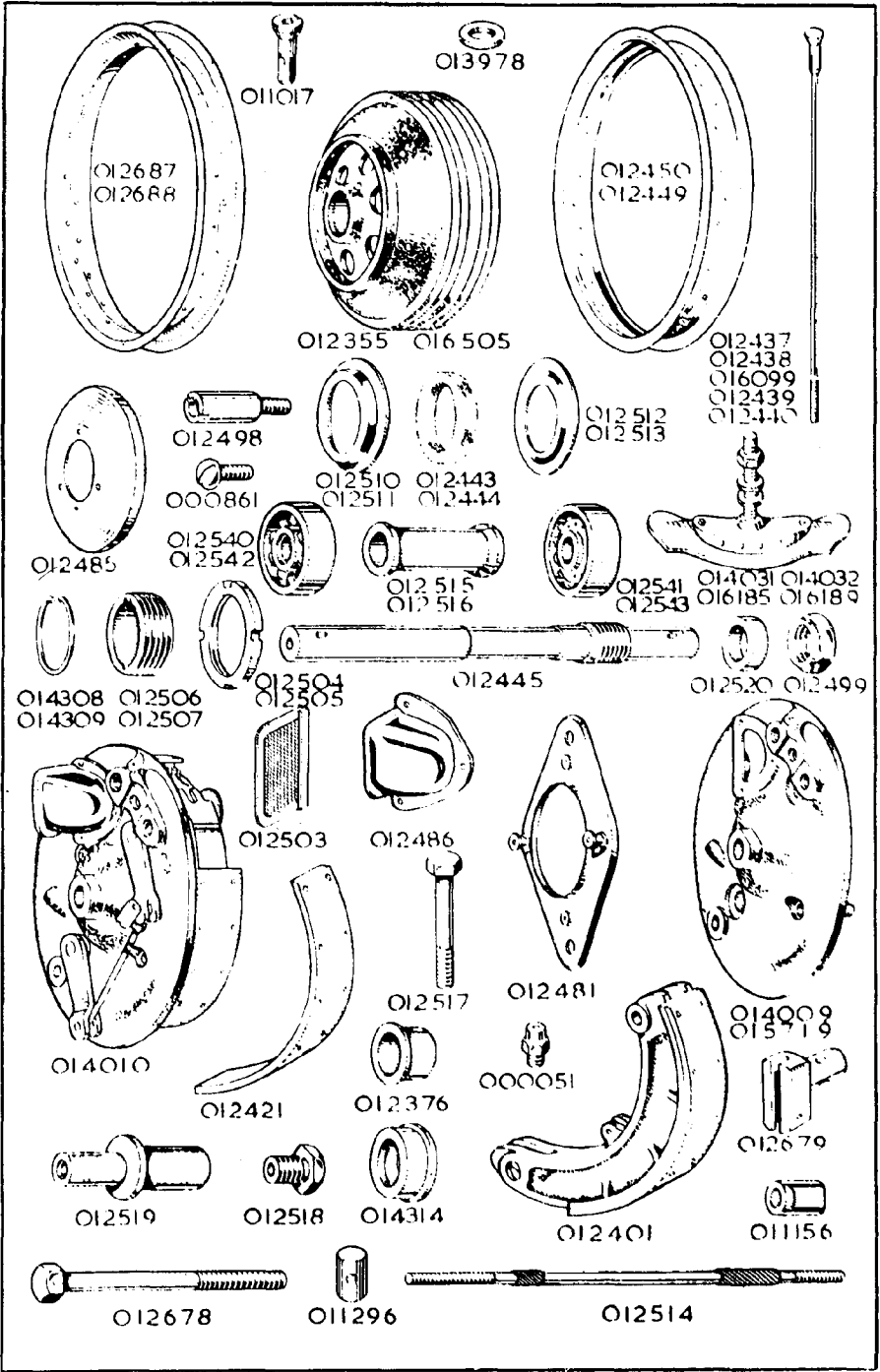

PART NUMBER	DESCRIPTION	QTY. OFF 49	QTY. OFF 50	Price on Application
REAR WHEEL				
012691	... Wheel, rear, assembly, steel rim (30).....	1	-	...
016506	... Wheel, rear, assembly, steel rim (30).....	-	1	...
016507	... Wheel, rear, assembly, alloy rim (30).....	1	-	...
016186	... Wheel, rear, assembly, alloy rim (30).....	-	1	...
016508	... Wheel, rear, bare, steel rim (31).....	1	-	...
016187	... Wheel, rear, bare, steel rim (31).....	-	1	...
016509	... Wheel, rear, bare, alloy rim (31).....	1	-	...
016188	... Wheel, rear, bare, alloy rim (31).....	-	1	...
012357	... Hub, rear, with brake liner (32).....	1	-	...
016510	... Hub, rear, with brake liner (32).....	-	1	...
012688	... Rim, rear wheel, steel.....	1	1	...
012449	... Rim, rear wheel, alloy.....	1	1	...
012439	... Spoke, rear wheel, right side.....	20	20	...
012440	... Spoke, rear wheel, left side.....	20	20	...
011017	... Nipple, rear wheel spoke.....	40	40	...
013978	... Washer, for spoke nipple (only used with alloy rim).....	40	40	...
014032	... Bolt, security, for rear tyre, alloy rim.....	2	2	...
016189	... Bolt, security, for rear tyre, steel rim.....	2	2	...
012484	... Cover, for right side of rear hub.....	1	1	...
013486	... Stud, $1\frac{3}{8}$ inch by $\frac{7}{8}$ inch by 26 and 20, retaining rear wheel sprocket.....	8	-	...
016250	... Stud, $1\frac{1}{2}$ inch by $\frac{5}{8}$ inch by 26 and 20, retaining rear wheel sprocket.....	-	8	...
014117	... Washer, shock proof, for sprocket fixing stud.....	8	8	...
000216	... Nut, retaining sprocket to rear hub stud.....	8	8	...
012542	... Bearing, ball, for rear hub (33).....	1	1	...
012543	... Bearing, roller, for rear hub (34).....	1	1	...
012516	... Spacer, $3\frac{3}{4}$ inches long, between rear hub bearings.....	1	1	...
012444	... Seal, oil, for rear hub bearings.....	2	-	...
012511	... Washer, cupped, for rear hub bearing.....	2	2	...
012513	... Washer, slightly dished, for rear hub bearing.....	2	2	...
014309	... Circlip, locating rear hub bearings.....	1	1	...
012507	... Ring, locating rear hub bearings.....	1	1	...
012505	... Nut, locking bearing locating ring, in rear hub.....	1	1	...
012446	... Spindle, for rear wheel.....	1	1	...
012525	... Washer, plain, for rear wheel spindle.....	2	2	...
012524	... Nut, for rear wheel spindle.....	2	2	...
012471	... Spacer, $1\frac{1}{2}$ inch long, on rear wheel spindle.....	1	-	...
015814	... Spacer, $1\frac{1}{2}$ inch long, with collar, on rear wheel spindle.....	-	1	...
012494	... Bush, plain, on rear wheel spindle (35).....	2	2	...
012495	... Bush, serrated, on rear wheel spindle (36).....	2	2	...
012488	... Carrier, for rear chain adjusting bolt.....	2	2	...
012491	... Bolt, adjusting rear chain.....	2	2	...
012521	... Nut, lock, for rear chain adjusting bolt.....	2	2	...

NOTE 30.—Comprises hub, rim, spokes and nipples, built up with bearings assembled.

NOTE 31.—Comprises hub, rim, spokes and nipples built up.

NOTE 32.—Brake liner is not supplied as a spare, return wheel to Factory when new liner is required.

NOTE 33.—Dimensions :—

Internal diameter $\frac{7}{8}$ inch.

External diameter 2 inches.

Thickness $\frac{7}{8}$ inch.

Manufacturer's Part Number is RLS-7.

NOTE 34.—Dimensions :—

Internal diameter $\frac{7}{8}$ inch.

External diameter 2 inches.

Thickness $\frac{7}{8}$ inch.

Manufacturer's Part Number is CRL-7.

NOTE 35.—These are located on the inside of each rear chain adjuster carrier.

NOTE 36.—These are located in each rear chain adjuster carrier.

PART NUMBER	DESCRIPTION	QTY. OFF 49	QTY. OFF 50	Price on Application
FRONT BRAKE				
014010	... Brake, assembly, for front wheel.....	1	-	...
015827	... Brake, assembly, for front wheel.....	-	1	...
014009	... Plate, cover, front brake, bare.....	1	-	...
015719	... Plate, cover, front brake, bare.....	-	1	...
012486	... Scoop, air, front brake cover plate.....	1	-	...
015823	... Scoop, air, front brake cover plate.....	-	1	...
012503	... Filter, for front brake air scoop.....	1	-	...
015826	... Filter, for front brake air scoop.....	-	2	...
000861	... Screw, $\frac{5}{16}$ inch by 2 B.A., fixing air scoop.....	3	-	...
000861	... Screw, $\frac{5}{16}$ inch by 2 B.A., fixing air scoop.....	-	8	...
016247	... Duct, for air, bottom, front brake plate.....	-	1	...
016246	... Duct, for air, top, front brake plate.....	-	1	...
016248	... Spacer, for air duct.....	-	2	...
000159	... Rivet, for air duct.....	-	6	...
014314	... Cap, inside.....	1	-	...
012376	... Bush, for brake cam lever (2 fitted in a lever).....	4	-	...
012519	... Pin, pivot, for brake shoes.....	2	-	...
012401	... Shoe, brake, with liner fitted, for front brake (37).....	2	-	...
012421	... Liner, for front brake shoe (38).....	2	-	...
000106	... Rivet, for front brake shoe liner, per set of 10 (39).....	20	-	...
012481	... Plate, tie, for front brake.....	1	-	...
012518	... Bolt, $\frac{7}{8}$ inch by $\frac{1}{8}$ inch by 26, securing tie plate to shoe pivot pin.....	2	-	...
012517	... Bolt, $1\frac{1}{2}$ inch by $\frac{1}{2}$ inch by 26, securing tie plate to brake cover plate.....	2	-	...
012496	... Spring, return, for brake shoe.....	4	-	...
012522	... Pin, anchor, for brake shoe return spring.....	4	-	...
012423	... Roller, for brake shoe.....	2	-	...
012424	... Axle, for brake shoe roller.....	2	-	...
012427	... Circlip, for brake shoe roller axle.....	2	-	...
012388	... Cam, for brake shoe operation.....	2	-	...
012387	... Lever, for brake shoe cam.....	2	-	...
000073	... Nut, retaining cam lever to brake shoe cam.....	2	-	...
000010	... Washer, plain, for cam lever retaining nut.....	2	-	...
013510	... Spring, return, for brake shoe cam.....	2	-	...
012523	... Pin, anchor, in cam, for cam return spring.....	2	-	...
012523	... Pin, anchor, in brake shoe, for cam return spring.....	2	-	...
003051	... Nipple, grease, for cam lever bearing.....	2	-	...
012514	... Rod, connecting brake shoe cam levers.....	1	-	...
011296	... Trunnion, for lower cam lever.....	1	-	...
011156	... Collar (with flats), for cam lever connecting rod.....	1	-	...
012679	... Pin (trunnion), for upper cam lever.....	1	-	...
000080	... Nut, lock, for cam lever connecting rod.....	1	-	...
000014	... Pin, split, retaining cable in trunnion pin.....	1	-	...
012678	... Bolt, $2\frac{3}{8}$ inches by $\frac{7}{8}$ inch by 22, securing front brake cover plate to fork slider.....	2	-	...
000011	... Washer, plain, for bolt securing cover plate to slider.....	2	-	...

NOTE 37.—Observe the price is that of one shoe only. (Two shoes are used in one front brake assembly.)

NOTE 38.—Observe the price is that of one liner only. (Two liners are used in one front brake assembly.) Price does not include rivets.

NOTE 39.—Observe one liner needs ten rivets. (Twenty rivets—two sets—are used in one front brake assembly.)

REAR BRAKE

014012	... Brake, assembly, for rear wheel.....	1	-	...
015828	... Brake, assembly, for rear wheel.....	-	1	...
014011	... Plate, cover, rear brake, bare.....	1	-	...
015721	... Plate, cover, rear brake, bare.....	-	1	...
015826	... Filter, for rear brake air outlet.....	-	1	...
000861	... Screw, $\frac{5}{16}$ inch by 2 B.A., fixing air filter.....	-	4	...
014321	... Cap, inside.....	1	-	...
012376	... Bush, for brake cam lever (2 fitted in a lever).....	4	-	...
012519	... Pin, pivot, for brake shoes.....	2	-	...
012372	... Shoe, brake, with liner fitted, for rear brake (40).....	2	-	...

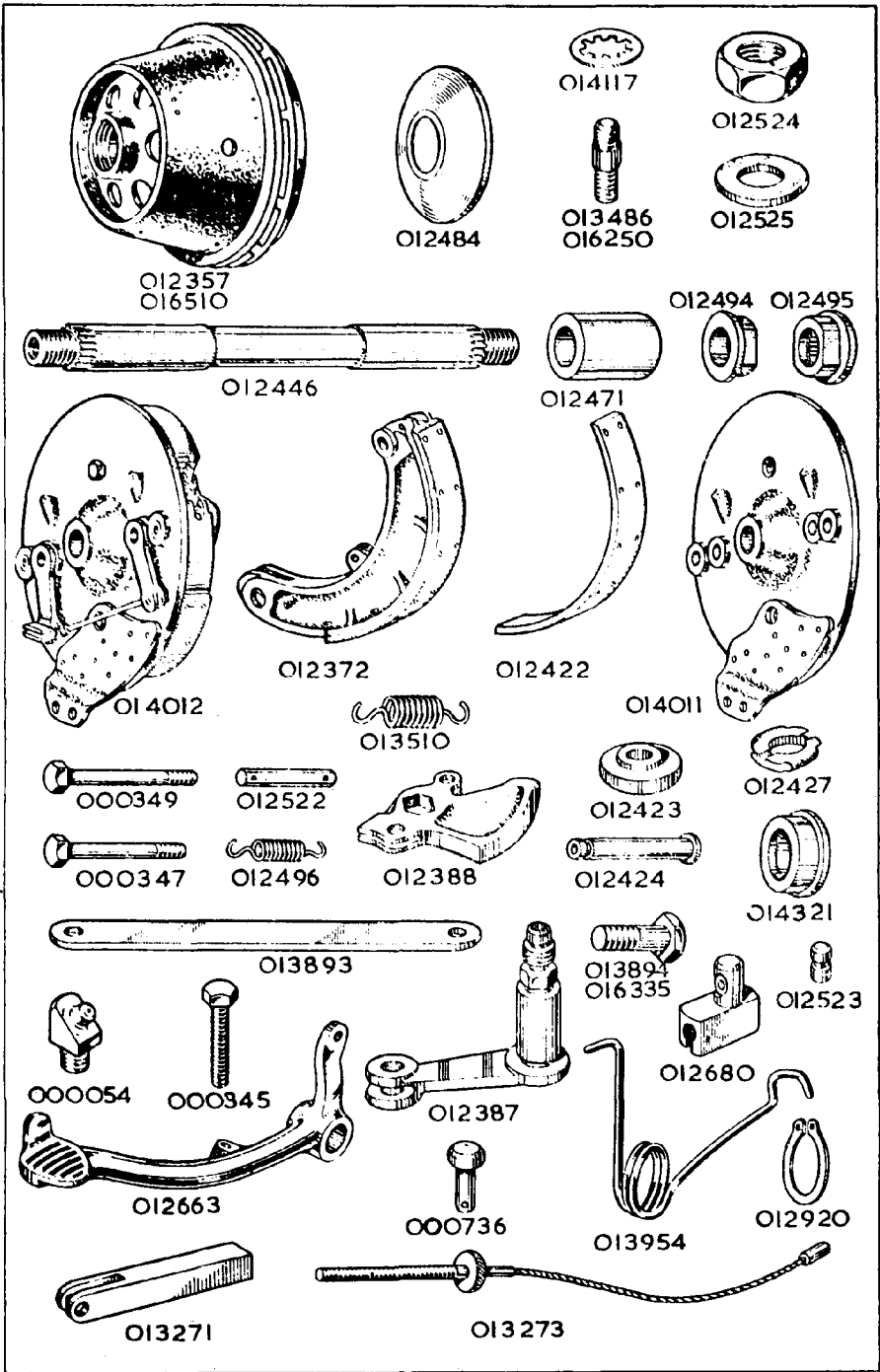

PART NUMBER	DESCRIPTION	QTY.	QTY.	Price on Application
		OFF 49	OFF 50	
012422	... Liner, for rear brake shoe (41).....	2	2	...
000106	... Rivet, for rear brake shoe liner, per set of 10 (42).....	20	20	...
012481	... Plate, tie, for rear brake.....	1	1	...
012518	... Bolt, $\frac{7}{16}$ inch by $\frac{7}{16}$ inch by 26, securing tie plate to shoe pivot pin.....	2	2	...
000349	... Bolt, $1\frac{1}{4}$ inch by $\frac{1}{4}$ inch by 26, securing tie plate to brake cover plate.....	1	1	...
000347	... Bolt, $1\frac{1}{4}$ inch by $\frac{1}{4}$ inch by 26, securing tie plate to brake cover plate.....	1	1	...
012496	... Spring, return, for brake shoe.....	4	4	...
012522	... Pin, anchor, for brake shoe return spring.....	4	4	...
012423	... Roller, for brake shoe.....	2	2	...
012424	... Axle, for brake shoe roller.....	2	2	...
012427	... Circlip, for brake shoe roller axle.....	2	2	...
012368	... Cam, for brake shoe operation.....	2	2	...
012387	... Lever, for brake shoe cam.....	2	2	...
000073	... Nut, retaining cam lever to brake shoe cam.....	2	2	...
000010	... Washer, plain, for cam lever retaining nut.....	2	2	...
013510	... Spring, return, for brake shoe cam.....	2	2	...
012523	... Pin, anchor, in cam, for cam return spring.....	2	2	...
012523	... Pin, anchor, in brake shoe, for cam return spring.....	2	2	...
000051	... Nipple, grease, for cam lever bearing.....	2	2	...
012514	... Rod, connecting brake shoe cam levers.....	1	1	...
011296	... Trunnion, for rear cam lever.....	1	1	...
011156	... Collar (with flats), for cam lever connecting rod.....	1	1	...
012680	... Pin (trunnion), for forward cam lever.....	1	1	...
016212	... Pin (trunnion), for forward cam lever.....	1	1	...
000080	... Nut, lock, for cam lever connecting rod.....	1	1	...
016213	... Washer, plain, for forward trunnion pin.....	1	1	...
000006	... Pin, split, for forward trunnion pin.....	1	1	...
016211	... Connection, banjo, for cable (fits on forward trunnion pin).....	1	1	...
000014	... Pin, split, retaining cable in trunnion pin.....	1	1	...
013893	... Link, coupling rear brake cover plate to rear fork.....	1	1	...
013894	... Bolt, $\frac{7}{8}$ inch by $\frac{3}{8}$ inch by 26, fixing coupling link to rear brake cover plate.....	1	1	...
016335	... Bolt, 1 inch by $\frac{3}{8}$ inch by 26, fixing coupling link to rear brake cover plate.....	1	1	...
000010	... Washer, plain, for link to cover plate bolt.....	1	1	...
000073	... Nut, for link to cover plate fixing bolt.....	1	1	...
000014	... Pin, split, locking nut on link to cover plate bolt.....	1	1	...
013895	... Stud, $1\frac{1}{2}$ inch by $\frac{1}{4}$ inch by 26 by 26, for rear brake coupling links.....	1	1	...
000010	... Washer, plain, for rear brake link stud.....	1	1	...
000003	... Nut, for rear brake link stud.....	1	1	...
000006	... Pin, split, locking rear brake link stud nut.....	1	1	...

NOTE 40.—Observe the price is that of one shoe only. (Two shoes are used in one rear brake assembly.)

NOTE 41.—Observe the price is that of one liner only. (Two liners are used in one rear brake assembly.)
Price does not include rivets.

NOTE 42.—Observe one liner needs ten rivets. (Twenty rivets—two sets—are used in one rear brake
assembly.)

REAR BRAKE OPERATING PARTS

012663	... Pedal, for rear brake, bare.....	1	1	...
000345	... Bolt, $1\frac{1}{8}$ inch by $\frac{1}{4}$ inch by 26, stop, for brake pedal.....	1	1	...
000005	... Nut, lock, for brake pedal stop bolt.....	1	1	...
000054	... Nipple, grease, for brake pedal.....	1	1	...
000203	... Washer, fibre, for brake pedal grease nipple.....	2	2	...
012920	... Circlip, retaining brake pedal.....	1	1	...
013954	... Spring, return, for brake pedal.....	1	1	...
013273	... Cable, assembled, for rear brake operation (43).....	1	1	...
013271	... End, yoke, for forward end of rear brake cable.....	1	1	...
000736	... Pin, for brake cable yoke end.....	1	1	...
000014	... Pin, split, for brake cable yoke end pin.....	1	1	...
017217	... Nut, lock, for brake cable adjustment.....	1	1	...

NOTE 43.—Includes the two "ends" which are integral with the cable and which are not supplied as
separate components.

CONTROL LEVER AND CABLE SECTION

PART NUMBER	DESCRIPTION	QTY. OFF 49	QTY. OFF 50	Price on Application
TWIST GRIP				
16-117	... Twist grip, complete assembly.....	1	1	...
16-070	... Grip, rubber, for twist grip.....	1	1	...
16-091	... Rotor, and sleeve, for twist grip (does not include rubber grip).....	1	1	...
16-060	... Body, twist grip, top (plain clip).....	1	1	...
16-061	... Body, twist grip, bottom (for friction spring).....	1	1	...
11-013	... Screw, long, clamping twist grip body.....	1	1	...
11-014	... Screw, short, clamping twist grip body.....	1	1	...
16-008	... Spring, friction, for twist grip.....	1	1	...
16-009	... Screw, for twist grip friction spring.....	1	1	...
16-010	... Nut, for twist grip friction spring.....	1	1	...
16-011	... Stop, for twist grip (throttle) cable.....	1	1	...
DUMMY GRIP				
16-069	... Grip, rubber, dummy.....	1	1	...
CLUTCH CONTROL LEVER				
18-556	... Lever, assembly, clutch.....	1	1	...
18-528	... Lever, only, clutch.....	1	1	...
18-234	... Bracket, clutch lever.....	1	1	...
12-040	... Clamp, clutch lever bracket.....	1	1	...
11-014	... Screw, clutch lever bracket clamp.....	2	2	...
18-087	... Pin, fulcrum, clutch lever.....	1	1	...
18-053	... Nut, clutch lever fulcrum pin.....	1	1	...
70-016	... Washer, lock, clutch lever fulcrum pin nut.....	1	1	...
FRONT BRAKE CONTROL LEVER				
18-557	... Lever, assembly, brake.....	1	1	...
18-535	... Lever, only, brake.....	1	1	...
18-234	... Bracket, brake lever.....	1	1	...
12-040	... Clamp, brake lever bracket.....	1	1	...
11-014	... Screw, brake lever bracket clamp.....	2	2	...
18-087	... Pin, fulcrum, brake lever.....	1	1	...
18-053	... Nut, brake lever fulcrum pin.....	1	1	...
70-016	... Washer, lock, brake lever fulcrum pin nut.....	1	1	...
AIR CONTROL LEVER				
12-161	... Lever, assembly, air.....	1	1	...
12-016-B	... Lever, only, air.....	1	1	...
12-007	... Bracket, air control lever.....	1	1	...
12-040	... Clamp, air lever bracket.....	1	1	...
11-014	... Screw, air lever bracket clamp.....	2	2	...
12-029	... Bolt, central, air lever.....	1	1	...
12-031	... Cap, air lever.....	1	1	...
12-033	... Washer, spring, air lever.....	1	1	...
IGNITION CONTROL LEVER				
12-171	... Lever, assembly, ignition.....	1	1	...
12-017-B	... Lever, only, ignition.....	1	1	...
12-008	... Bracket, ignition control lever.....	1	1	...
12-040	... Clamp, ignition lever bracket.....	1	1	...
11-014	... Screw, ignition lever bracket clamp.....	2	2	...
12-029	... Bolt, central, ignition lever.....	1	1	...
12-031	... Cap, ignition lever.....	1	1	...
12-033	... Washer, spring, ignition lever.....	1	1	...

PART NUMBER	DESCRIPTION	QTY.	QTY.	Price on Application
		OFF 49	OFF 50	

FRONT BRAKE CABLE

016511	Cable, complete, assembled, front brake (tip to tip length, 37 $\frac{1}{4}$ inches)	1	1	
12-39	Wire, inner, front brake, 37 $\frac{1}{4}$ inches long	1	1	
013971	Nipple, brake end, brake inner wire	1	1	
18-088	Nipple, handlebar end, brake inner wire	1	1	
12C-27	Casing, outer, front brake, 27 inches long	1	1	
000531	Ferrule, front brake outer casing	2	2	
011348	Adjuster, front brake cable	1	1	
16363	Nut, lock, front brake cable adjuster	1	1	
012674	Guide	1	1	

CLUTCH CABLE

016512	Cable, complete, assembled, clutch (tip to tip length 54 $\frac{1}{2}$ inches)	1	1	
12-56	Wire, inner, clutch, 54 $\frac{1}{2}$ inches long	1	1	
4	Nipple, gear box end, clutch inner wire	1	1	
18-088	Nipple, handlebar end, clutch inner wire	1	1	
12C-50 $\frac{1}{2}$	Casing, outer, clutch, 50 $\frac{1}{2}$ inches long	1	1	
000531	Ferrule, clutch outer casing	2	2	
014225	Adjuster, clutch cable	1	1	
000290	Nut, lock, clutch cable adjuster	1	1	

IGNITION CONTROL CABLE (Lucas Magneto)

39-I-1	Cable, complete, assembled, ignition (tip to tip length 42 $\frac{1}{2}$ inches)	1	1	
11-44	Wire, inner, ignition, 42 $\frac{1}{2}$ inches long	1	1	
MC-4	Nipple, magneto end, ignition inner wire	1	1	
12-034	Nipple, handlebar end, ignition inner wire	1	1	
11C-39 $\frac{1}{2}$	Casing, outer, ignition, 39 $\frac{1}{2}$ inches long	1	1	
000528	Ferrule, ignition outer casing	2	2	
MC-7	Adjuster, ignition cable	1	1	
MC-8	Nut, lock, ignition cable adjuster	1	1	

IGNITION CONTROL CABLE (B.T.H. Magneto)

016513	Cable, complete, assembled, ignition (tip to tip length 53 $\frac{3}{4}$ inches)	-	1	
11-55	Wire, inner, ignition, 53 $\frac{3}{4}$ inches long	-	1	
016516	Nipple, magneto end, ignition inner wire	-	1	
12-034	Nipple, handlebar end, ignition inner wire	-	1	
11C-49 $\frac{1}{2}$	Casing, outer, ignition, 49 $\frac{1}{2}$ inches long	-	1	
000528	Ferrule, ignition outer casing	-	2	
016514	Adjuster, ignition cable	-	1	
016515	Nut, lock, ignition cable adjuster	-	1	

THROTTLE CONTROL CABLE

015206	Cable, complete, assembled, throttle (tip to tip length 43 inches)	1	1	
SW2-45	Wire, inner, throttle, 43 inches long	1	1	
1482	Nipple, carburettor end, throttle inner wire	1	1	
12-034	Nipple, handlebar end, throttle inner wire	1	1	
11C-38 $\frac{1}{2}$	Casing, outer, throttle, 38 $\frac{1}{2}$ inches long	1	1	
000528	Ferrule, throttle outer casing	2	2	

AIR CONTROL CABLE

015207	Cable, complete, assembled, air (tip to tip length 40 $\frac{1}{2}$ inches)	1	1	
11-42	Wire, inner, air, 40 $\frac{1}{2}$ inches long	1	1	
1482	Nipple, carburettor end, air inner wire	1	1	
12-034	Nipple, handlebar end, air inner wire	1	1	
11C-36 $\frac{1}{4}$	Casing, outer, air, 36 $\frac{1}{4}$ inches long	1	1	
000528	Ferrule, air outer casing	2	2	

SUNDRIES SECTION

PART NUMBER	DESCRIPTION	QTY.	QTY.	Price on Application
		OFF 49	OFF 50	
TOOLS				
17520	... Bag, for tools.....			...
L-TK-13	... Screwdriver
L-TK-15	... Pliers, side cutting.....			...
L-TK-20	... Gun, grease
38-G3-EQ-2	... Inflator, tyre
40-G3-TK-29	... Lever, tyre.....	2	2	...
41-G3L-TK-1	... Spanner, double end, $\frac{3}{8}$ inch by $\frac{1}{4}$ inch
41-G3L-TK-2	... Spanner, double end, $\frac{5}{8}$ inch by $\frac{3}{8}$ inch
3263	... Spanner, double end, $\frac{1}{2}$ inch by .375 inch
17634	... Spanner, box, with tommy, for sparking plug.....			...
11914-S	... Spanner, hook, for hub bearings.....			...
015023	... Spanner, double end, with gauge, for contacts.....			...
RTK-4	... Spanner, double end, 1-390 inch by 1-390 inch.....			...
013909	... Spanner, box, with tommy, for cylinder head nuts.....			...
013896	... Spanner, pin, for exhaust pipe nut.....			...
LTK-12	... Spanner, adjustable, 6 inch size
015038	... Spanner, box, for crankpin, six tooth	-		...
016496	... Spanner, box, for crankpin, eight tooth	-		...
015039	... Tommy, for crankpin spanner.....	-		...
013965	... Holder, for camshaft chain sprocket.....			...
016426	... Key, Allen type, $\frac{1}{8}$ inch.....	-		...
015184	... Compressor, valve spring, complete.....	-		...

VARIOUS

011957	... "TEKALL," rust preventative, $\frac{1}{2}$ pint tin.....	R	R	...
011958	... "TEKALL," rust preventative, 1 pint tin.....	R	R	...
B-A-H	... Badge, monogram, A-J-S, for buttonhole.....	R	R	...
B-A-T	... Badge, monogram, A-J-S, for tie.....	R	R	...
B-A-B	... Badge, monogram, A-J-S, for brooch fixing.....	R	R	...
011909	... Clip, rubber, retaining control cables to frame.....	3	3	...
015955	... Disc, timing	1	1	...



ALWAYS QUOTE

THE COMPLETE ENGINE NUMBER

(Including all the Letters in it).

THIS ENABLES US TO IDENTIFY THE MACHINE.

EACH SERIES OF FRAMES IS NUMBERED FROM ZERO UPWARDS. THEREFORE THE QUOTATION OF A FRAME NUMBER ONLY DOES NOT PERMIT A MACHINE TO BE IDENTIFIED.

DETAILED INDEX

	Page		Page
BRAKES	38	LEVERS, CONTROL	41
CARBURETTER	13	OFFICE INFORMATION	2
CABLES	42	How to order spares	2
ENGINE		Repairs	3
Big-End bearings	6	Service	3
Connecting rod	6	Terms of Business	2
Crankcase	6	PIPES	
Cylinder	5	Exhaust	15
Cylinder head	5	Oil	34
Oil pumps	8	Petrol	33
Piston	5	SEAT	31
Rockers	10	SERVICE	3
Timing	7	How to reach Factory	facing page 1
Valves	5	TANKS	
ENGINE PLATES		Oil	33
Plates	24	Fuel	33
Crankcase bolts	6	TOOLS	43
FOOTRESTS	29	TRANSMISSION	
FRAME	24	Chains	16
Rear fork	29	Gear box, 1949	17
Teledraulic rear leg	31	Gear box, 1950	21
FRONT FORKS	26	Sprocket, engine	16
Handlebar	26	Sprocket, rear wheel	16
Parts	2	WHEELS	
Steering damper	27	Wheel and parts, front	35
GRIPS		Wheel and parts, rear	37
Dummy	41	VARIOUS	
Twist	41	Rust preventative	43
GUARDS		Badges	43
Chaincase, front	29		
Mudguard, front	27		
Mudguard, rear	29		

